

28803
38089 14

T.36S.R.11&12E.W.M.

whiskey Ck & MISC.

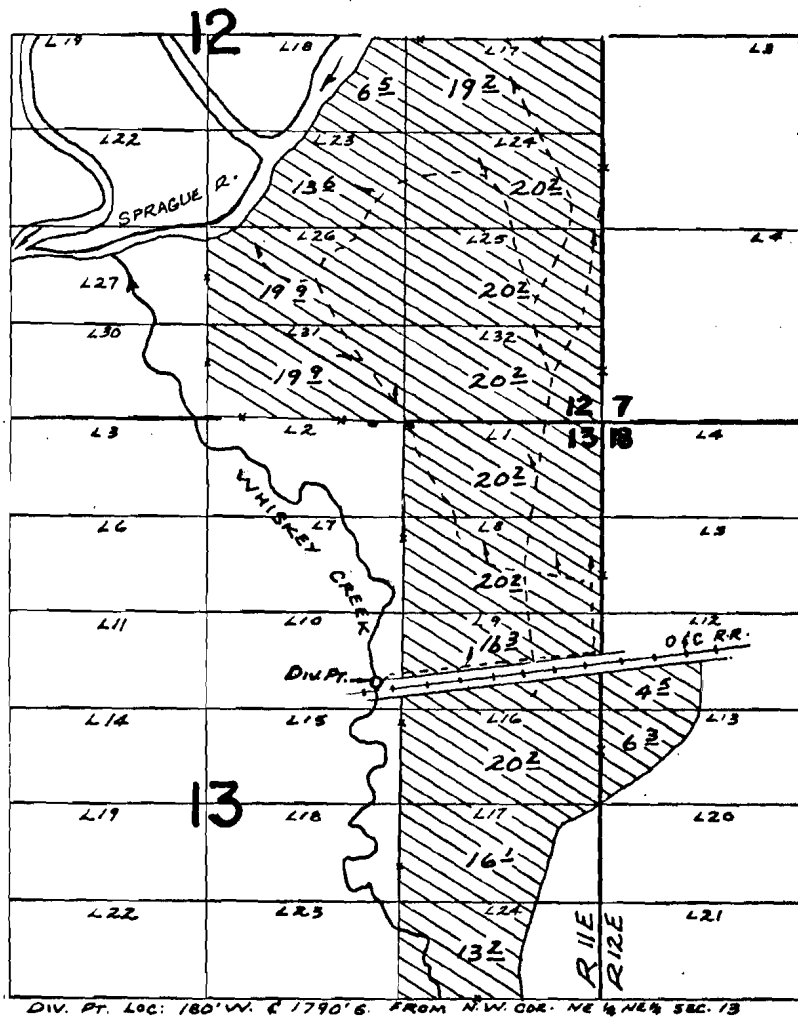

FINAL PROOF SURVEY UNDER

Application No. 38227... Permit No. 28803...
IN NAME OF

W. M. & ELIZABETH A. WILLIAMS

Surveyed MAY 20 1970, by R. MURKIN.....