

T. 15 S. R. 4 & 5 W. W. M.

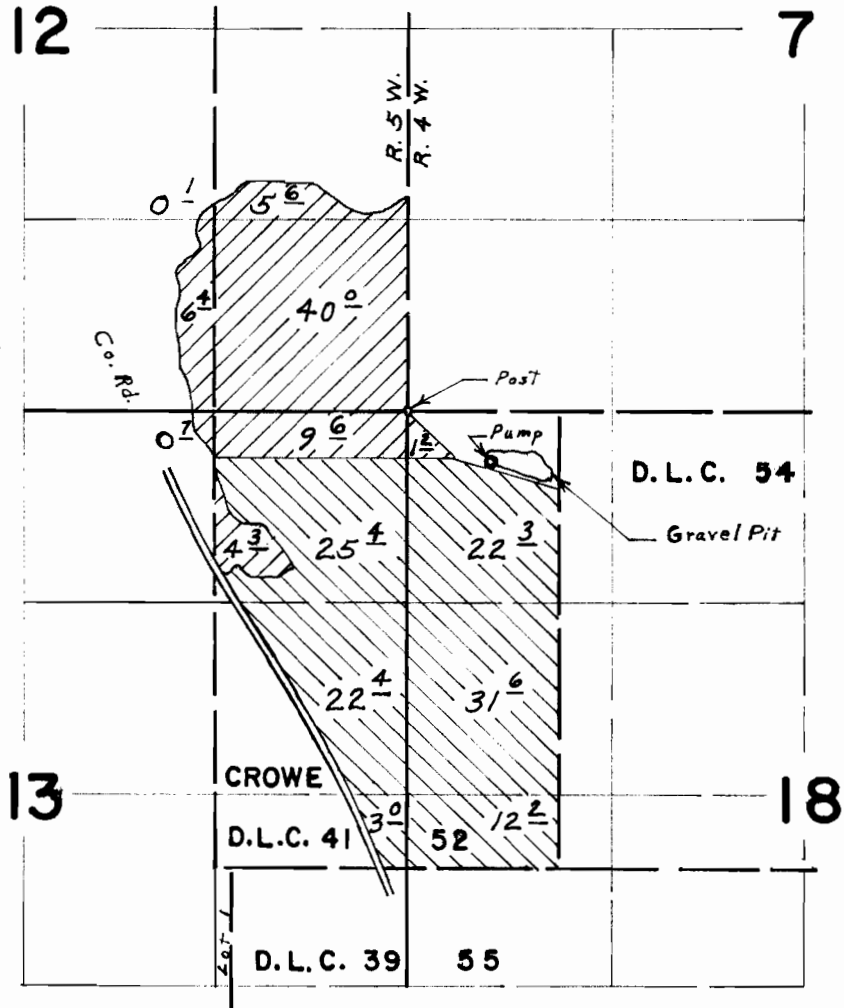

Well located 350' S. & 750' E. from N.W. Cor. Sec. 18

FINAL PROOF SURVEY

BOOK

G-3518 G-3310
 G-4273 G-4024

IN NAME OF

GIBSON LAND & LIVESTOCK CO.

Surveyed June 5, 1970, by L. E. Gould