

P-32478 6
38185

T.1N.R.19E.W.M.

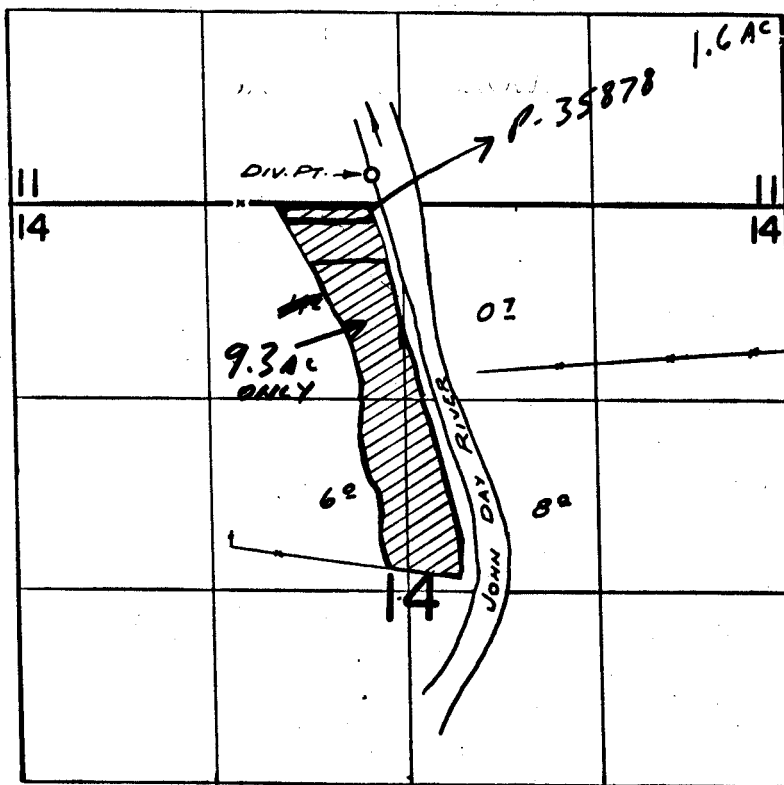

DIV. PT. LOC: 8150' N. & 2950' W. FROM S. 1/4 COR. SEC. 23

FINAL PROOF SURVEY UNDER

14
23

Application No. 43602 Permit No. 32478
IN NAME OF C. 38185

ROY S. FERRIS

Surveyed OCT. 1970, 1970, by R. MUCKEN.

—O—STONE WITH "S"