

T. 14 S. R. 6 W. W. M.

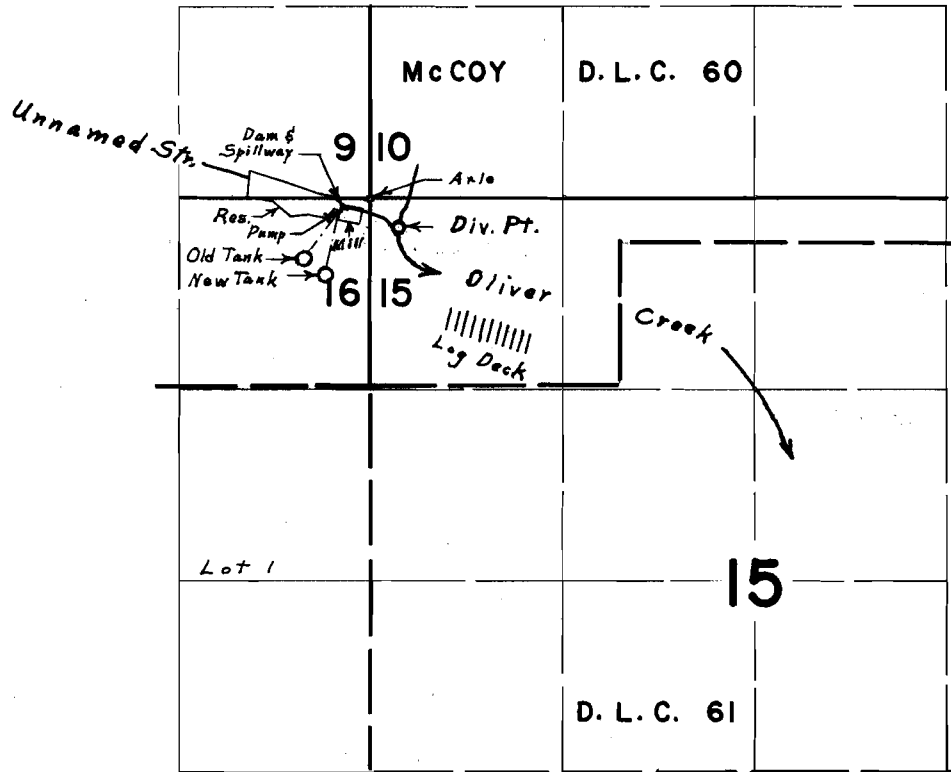

Div. Pt. located; 70' S. & 180' W. from N.E. Cor. Sec. 16

FINAL PROOF SURVEY

UNDER

Application No. R-40084 40085 Permit No. R-4463 29898

IN NAME OF

HULL-OAKES LUMBER COMPANY

Surveyed May 8, 1970, by L. E. Gould