

T. 35 S. R. 4 W. W. M.

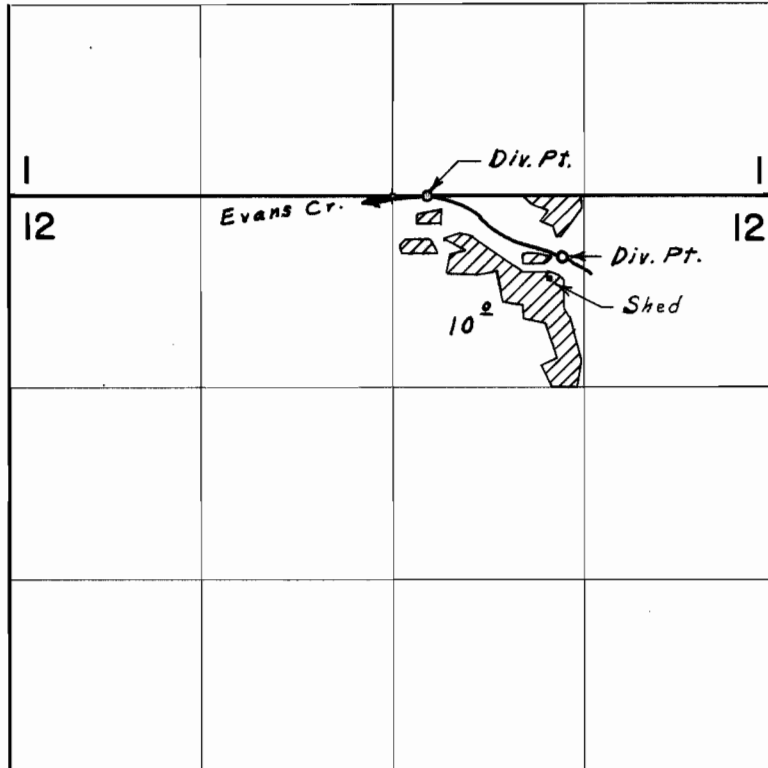

Div. Pts. located: 5' S. & 230' E.; 420' S. & 1170' E.; both from N. & Cor. Sec. 12.

FINAL PROOF SURVEY UNDER

Application No. 39811 Permit No. 29586
IN NAME OF

RICHARD E. OLYMPIUS

Surveyed May 11, 1971, by L. E. Gould