

# T. 4 N. R. 28 E. W. M.

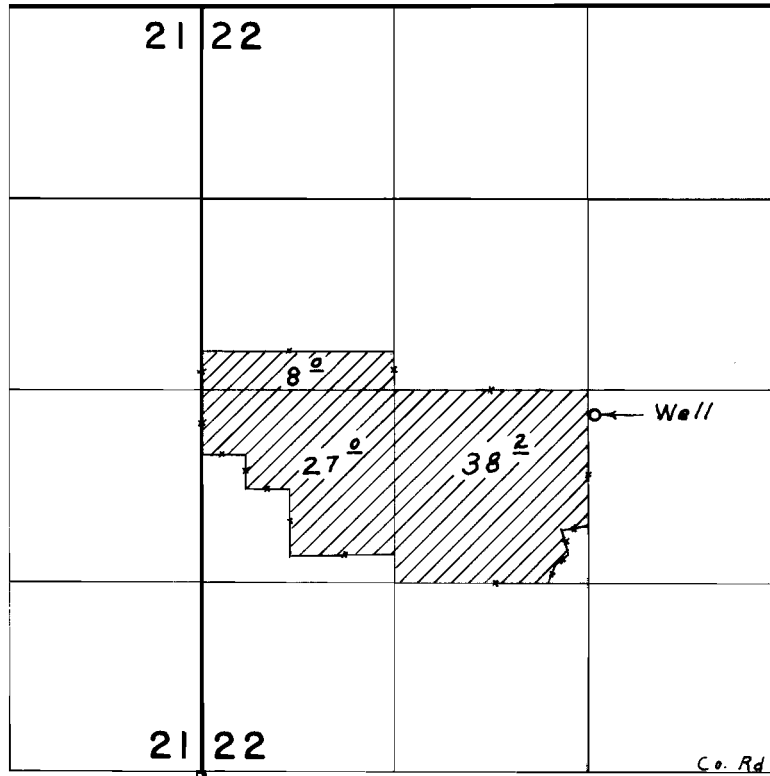

Well located 2480' N. & 2680' E. from S.W. Cor. Sec. 22

## FINAL PROOF SURVEY UNDER

Application No. G-4278 Permit No. G-4027  
IN NAME OF

C. & B. LIVESTOCK, INC.

Surveyed June 26, 1971, by L. E. Gould