

T.2N.R3&4W.W.M.

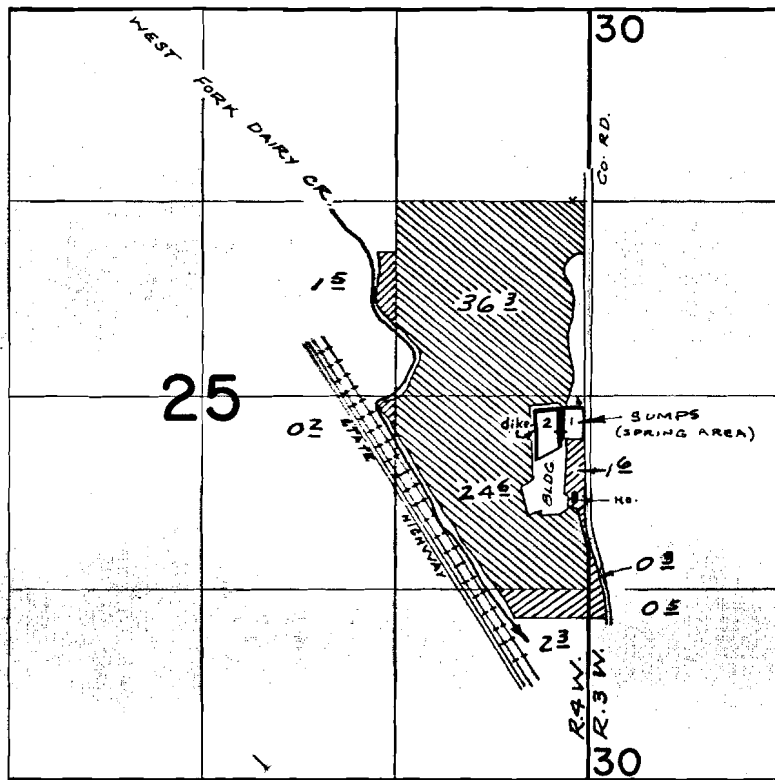

SPRING AREA LOC: .530' S. of 100' W. FROM N.E. COR. SE 1/4 NE 1/4 SEC. 25

 → PRIMARY
  → SUPPLEMENTAL

FINAL PROOF SURVEY
UNDER

R-48418 R-5959
 48419 36745
 R-43201 R-4997
 Application No. 43202 Permit No. 32296
 IN NAME OF

JOSEPH A. EVERS

Nov. 2, 1977 J. S. Donaldson
 Surveyed JUNE 18, 1971, by R. MUCKEN