

T. 6 & 7S. R. 45E. W.M.

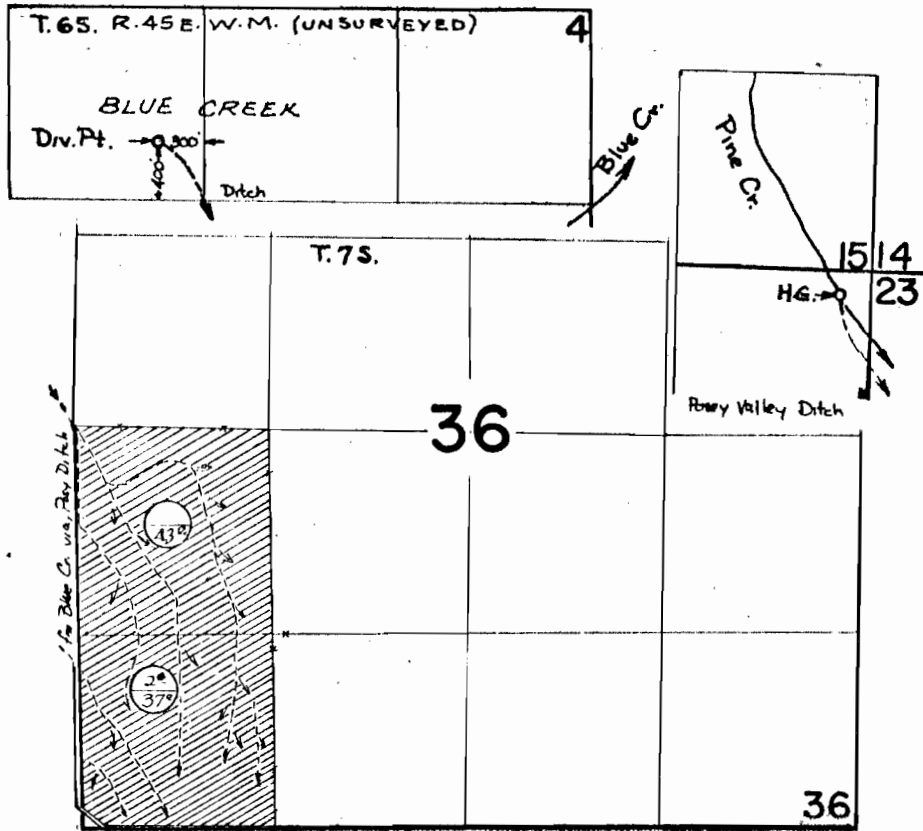

NOTE: DIV. PT. LOCATION, FROM APPLICANTS MAP
 IS IN APPROXIMATE LOCATION. SECTION 4
 IS UNSURVEYED

○ Pri.
 ○ Supp.

FINAL PROOF SURVEY

UNDER

Application No. **38563** Permit No. **28730**

IN NAME OF

LOUISE W. SLY & RALPH L. MAKINSON

Surveyed **17 JULY 1970**, by **D. R. BUELL**