

T. 35 S. R. 3 W. W. M.

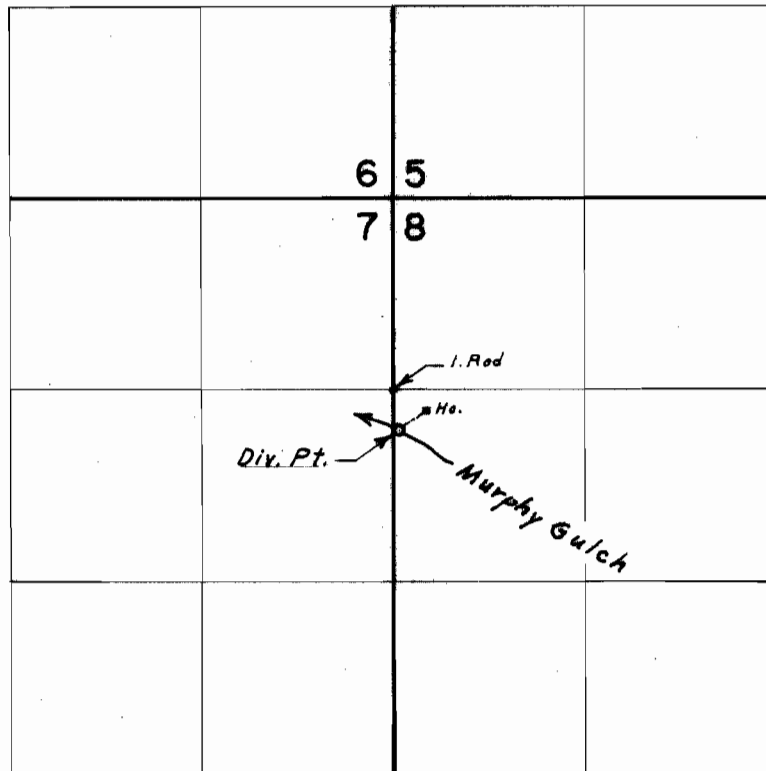

*Div. Pt. located 2.80' S. & 30' E. N.W. Cor. S.W. 1/4 N.W. 1/4 Sec. 8*

**FINAL PROOF SURVEY**  
UNDER

Application No. 43695 Permit No. 32657  
IN NAME OF

ALBERT C. WRIGHT

Surveyed May 11, 1971, by L. E. Gould