

T. 1 S. R. 24 E. W. M.

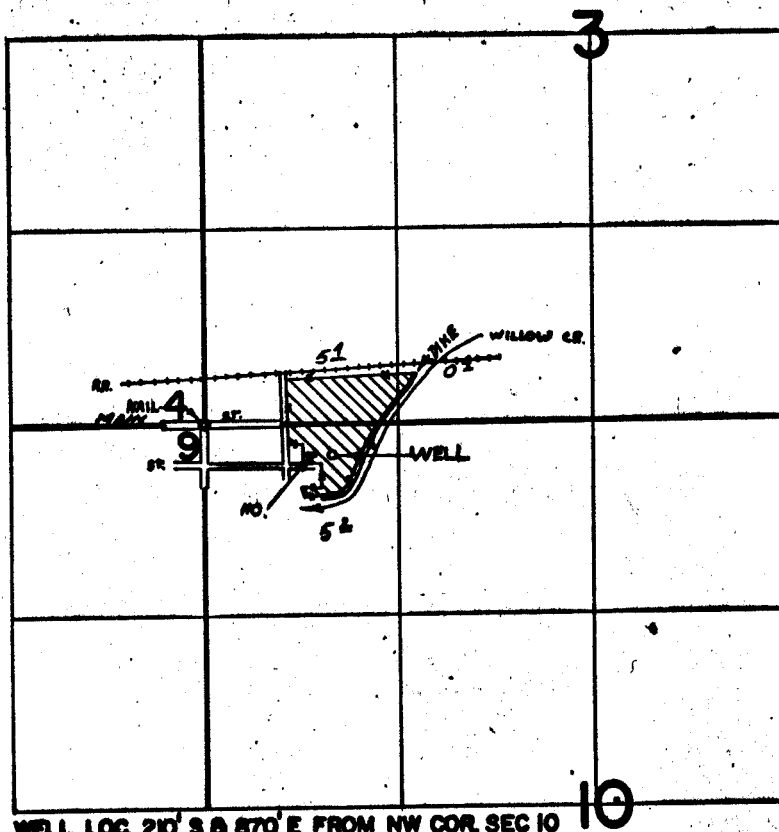

WELL LOC. 210' S & 570' E FROM NW COR. SEC 10

FINAL PROOF SURVEY UNDER

Application No. G-4775 Permit No. G-4498
IN NAME OF

PAUL PETTYJOHN

Surveyed MAY 5, 1971, by R. MUCKEN