

G-3541  
38388 7

# T. 4 N. R. 28 E. W. M.

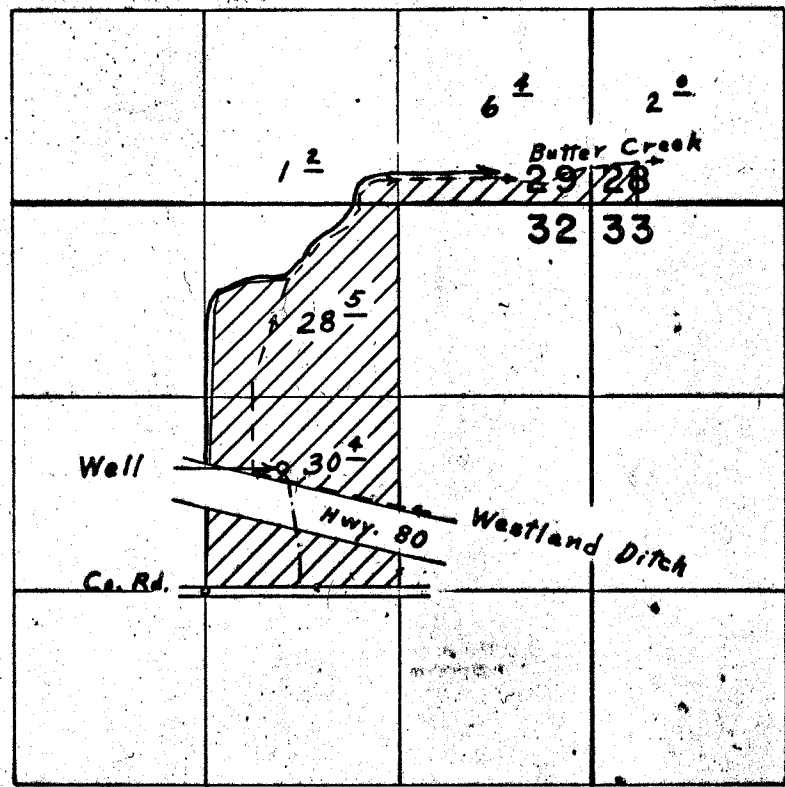

Well located 820' N. & 520' E. from Center Section 28

## FINAL PROOF SURVEY UNDER

Application No. G-3749 Permit No. G-3541  
IN NAME OF

MRS. ROSE MUELLER

Surveyed June 28, 1971, by L. E. Gould