

T. 4 N. R. 28 E. W. M.

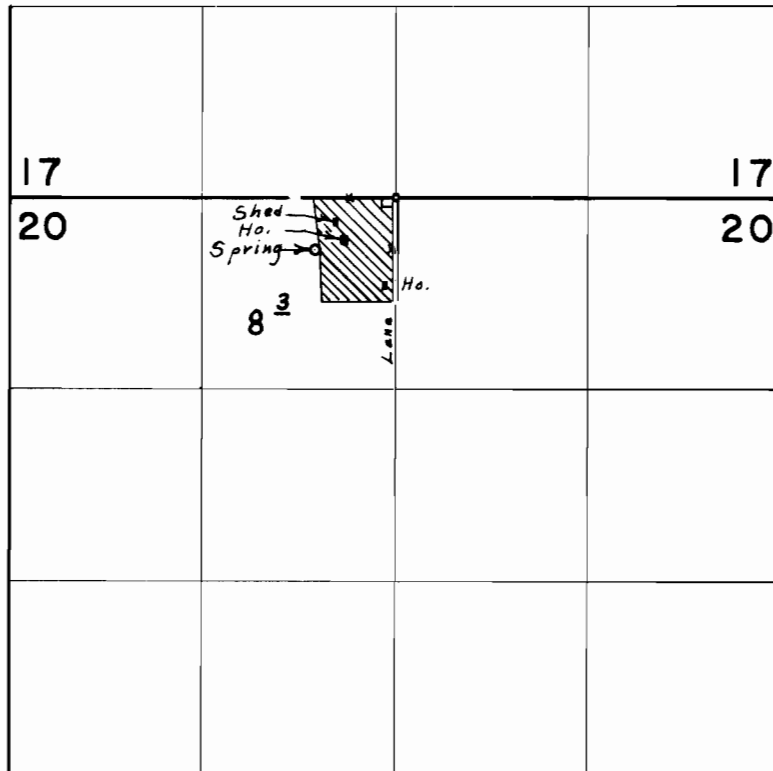

Spring located 360' S. & 550' W. from N. & Cor. Sec. 20

FINAL PROOF SURVEY UNDER

Application No. 45.125 Permit No. 33718
IN NAME OF

JACK & SONJA THOMPSON

Surveyed June 25, 1971, by L. E. Gould