

T.8&9S.R.38E.W.M.

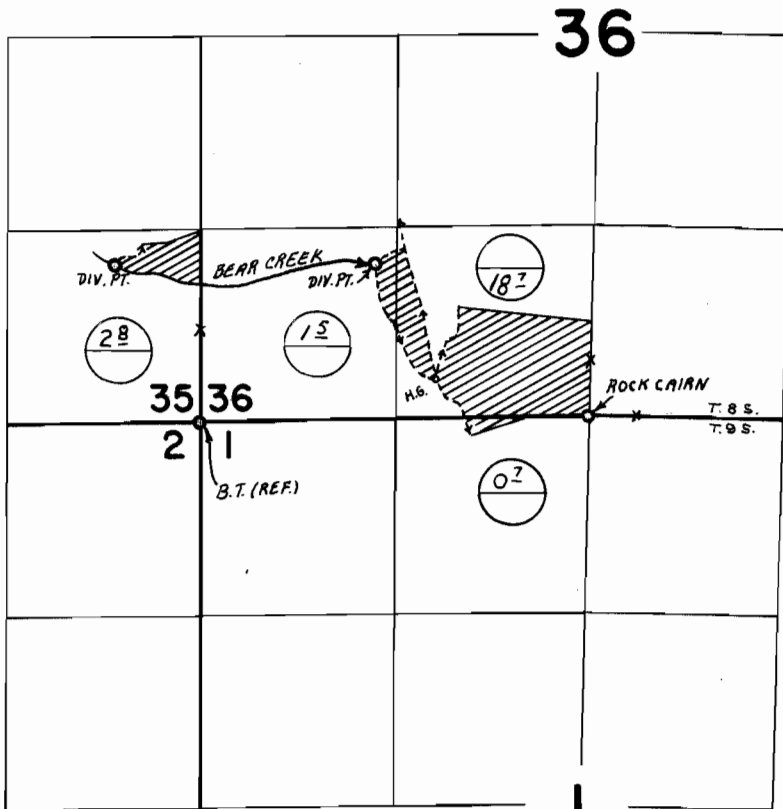

DIV. PTS. LOC: 1070' N. & 590' W.; 1080' N. & 1200' E.; BOTH FROM SW COR. SEC. 36



PERMIT NO. 28839
PRIOR RIGHT C-4155

FINAL PROOF SURVEY UNDER

Application No. 38749 Permit No. 28839
IN NAME OF

OSCAR H. COEN

Surveyed JULY 13 1970, by L. E. GOULD