

# T.13S.R.5&4W.W.M.

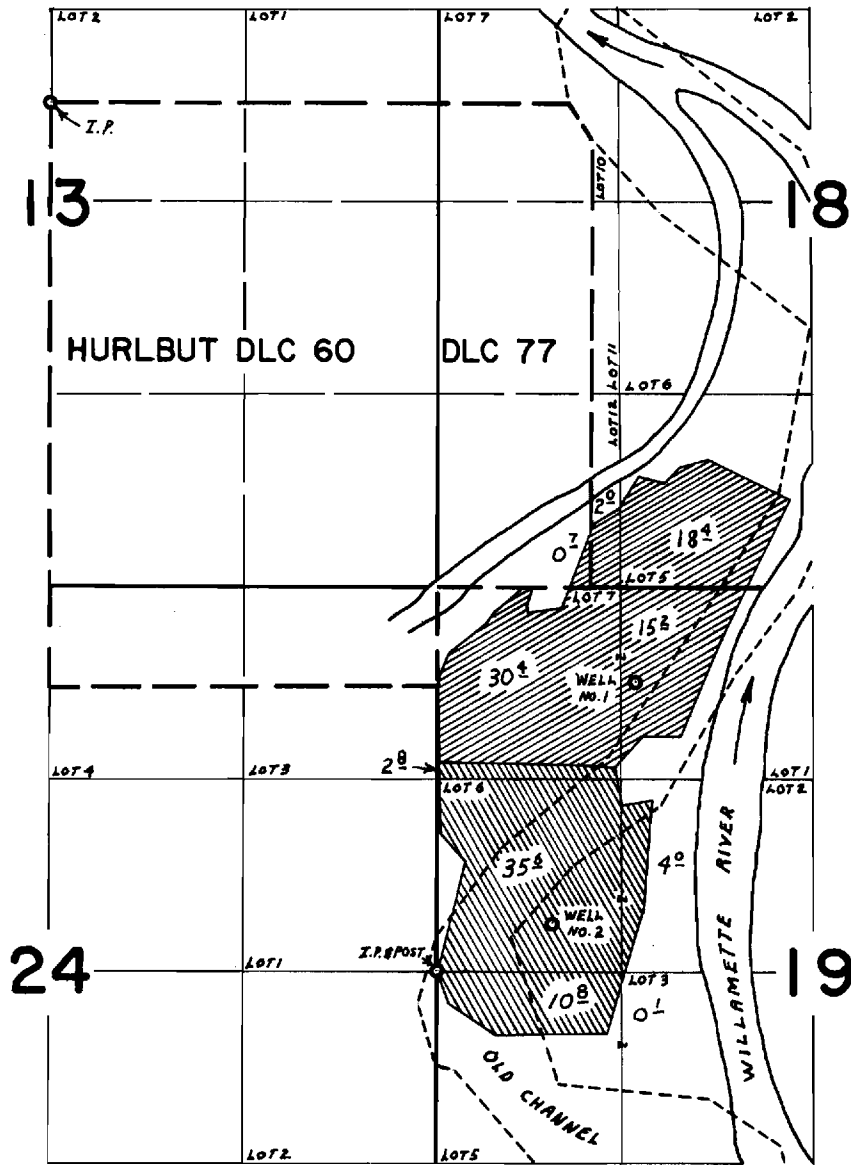

WELLS LOC.: WELL 1 - 1990' N. & 1370' E.; WELL 2 - 330' N. & 800' E.;  
BOTH FROM W 1/4 COR. SEC. 19

## FINAL PLAT OF SURVEY

1970-5

Application No. G-4603 and G-4327

Division of

**HILBERT SIM FARM INC.**

Surveyed AUG. 31, 1970, by L. E. GOULD