

# T. 2 S. R. 3 E. W. M.

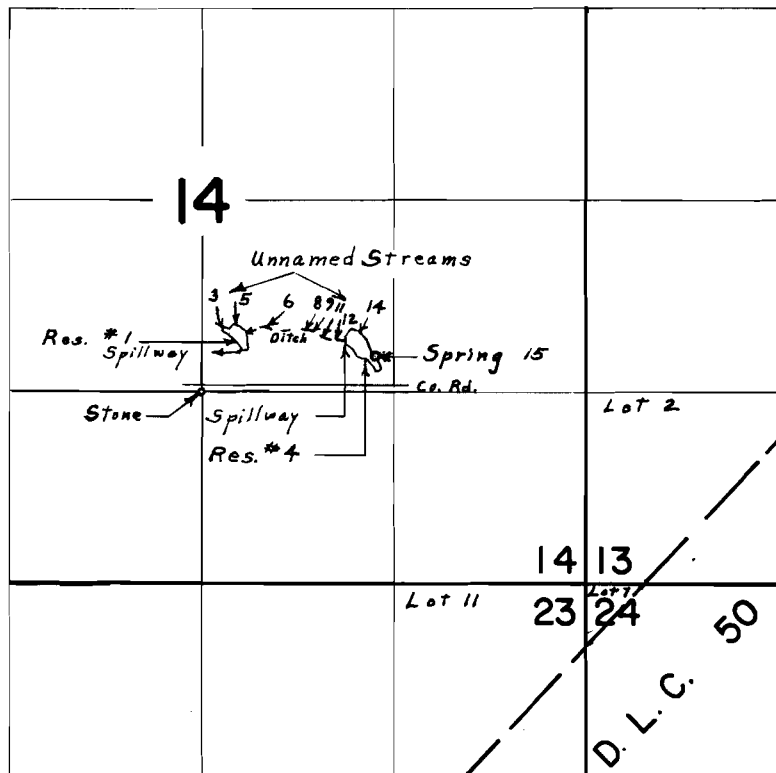

Div. Pts. located: Res. #1, 290' N. & 270' E.; Res. #4, 340' N. & 280' E.;  
 Ditch, 440' R. & 440' E.; 430' N. & 710' E.; 420' N. & 770' E.; 380' N. &  
 830' E.; 360' N. & 930' E.; Spring, 240' N. & 1180' E. all from  
 S.W. Cor. N.W.  $\frac{1}{4}$  S.E.  $\frac{1}{4}$  Sec. 14

## FINAL PROOF SURVEY UNDER

R-39131                      R-3886  
 Application No. 39015      Permit No. 29211  
 IN NAME OF

GLEN L. ALTHAUSER

Surveyed Nov. 10, 1970, by L. E. Gould