

P 31948
38437
38436

RECEIVED T.I.S.R.21&22E.W.M.
FEB 6 1976
WATER RESOURCES DEPT
SALEM, OREGON

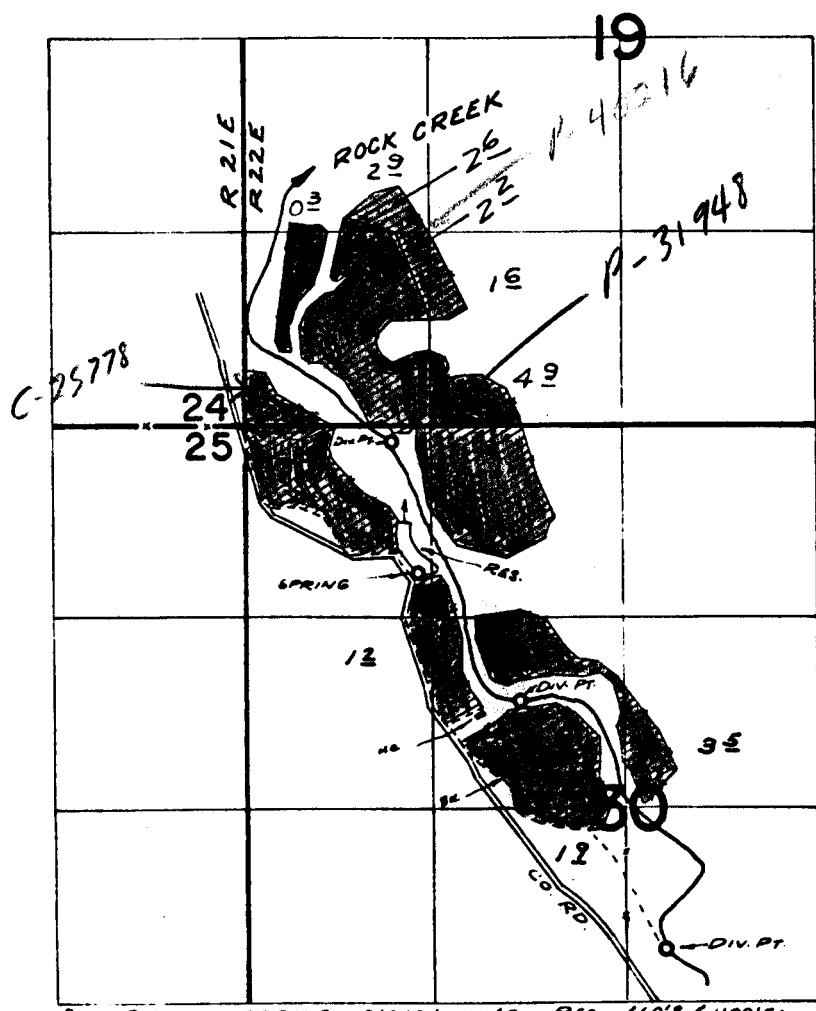

DIV. PTS. Loc: SPRING - 1010'S & 1180'E; RES - 660'S & 1100'E;
CREEK - 120'S & 1020'E; 1900'S & 1800'E; 3580'S & 2870'E;
ALL FROM N.W. COR. SEC. 30

*This Application
Does not claim a water Right.*

FINAL PROOF SURVEY

UNDER

Application No. **42931** ~~R-43094~~ ~~P-4860~~ **31948**
~~R-4860~~

IN NAME OF

R. E. IRBY

Surveyed **OCT. 29, 1970** by **R. MUCKEN**

Application No. 53897
Permit No. 40216