

P 31948  
38437  
38436

**RECEIVED** T.I.S.R.21&22E.W.M.  
FEB 6 1976  
WATER RESOURCES DEPT  
SALEM, OREGON

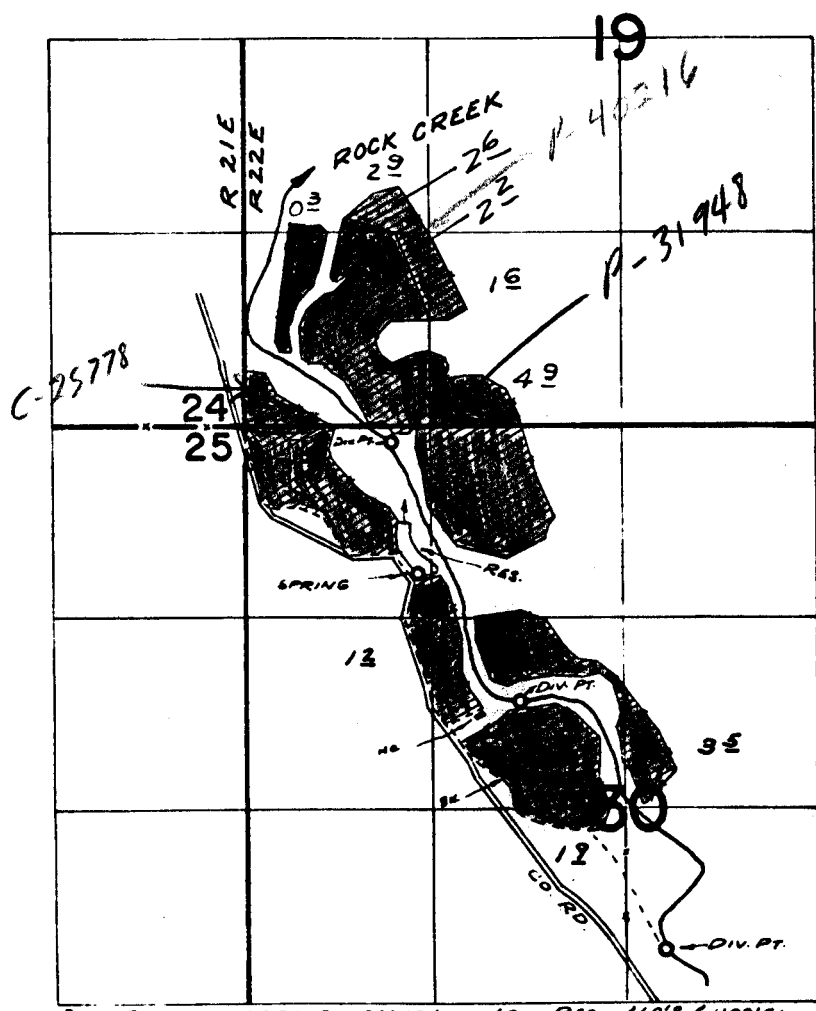

DIV. PTS. Loc: SPRING - 1010'S & 1180'E; RES - 660'S & 1100'E;  
CREEK - 120'S & 1020'E; 1900'S & 1800'E; 3580'S & 2870'E;  
ALL FROM N.W. COR. SEC. 30

*This Application  
Does not claim a water Right.*

**FINAL PROOF SURVEY**

UNDER

Application No. **42931** **31948**  
~~R-43094~~ ~~P-4860~~

IN NAME OF

**R. E. IRBY**

APPROVED **OCT. 29, 1970** by **R. MUCKEN**

Application No. **53897**  
Permit No. **40216**