

T 33 S. R. 2 E. W. M.

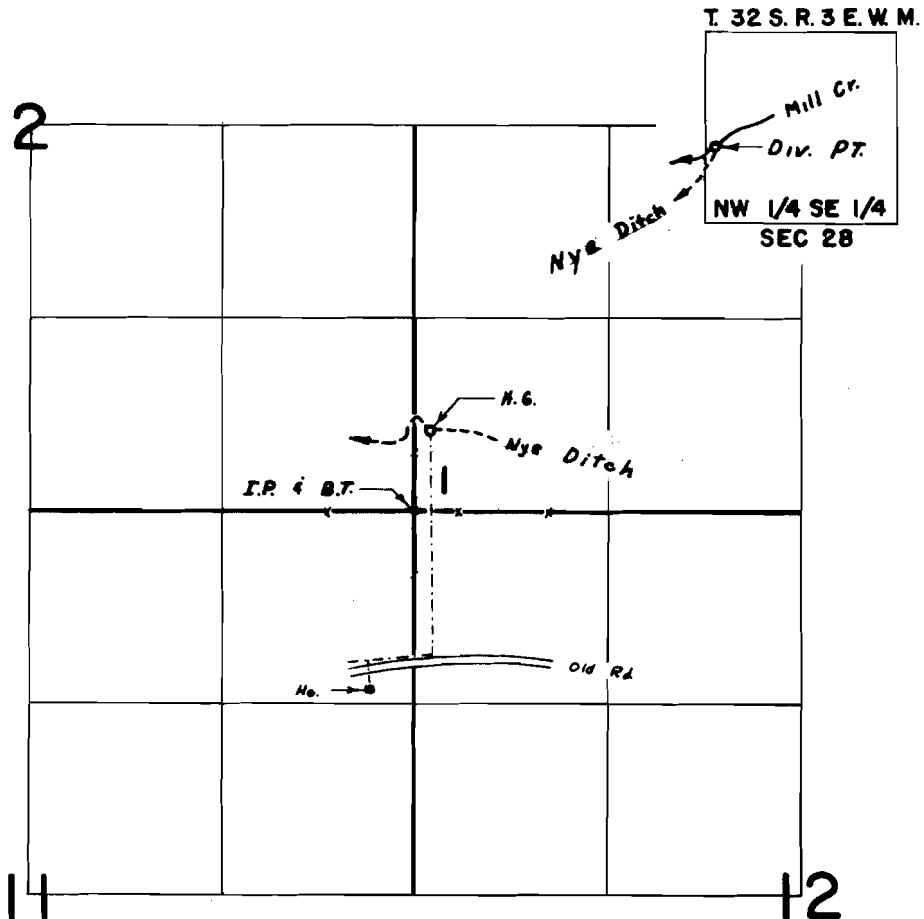

DIV. PT. LOC. 1860' N & 2690' E FROM SW COR. SEC. 28 T. 32 S. R 3 E. W. M.

FINAL PROOF SURVEY
UNDER

Application No. 41854..... Permit No. 31320.....
IN NAME OF

CLARENCE G. & OR MABEL L. HEDGPETH

Surveyed SEP. 16, 1971, by L. E. Gould.....