

T. 38 S. R. 7 & 8 W. W.M.

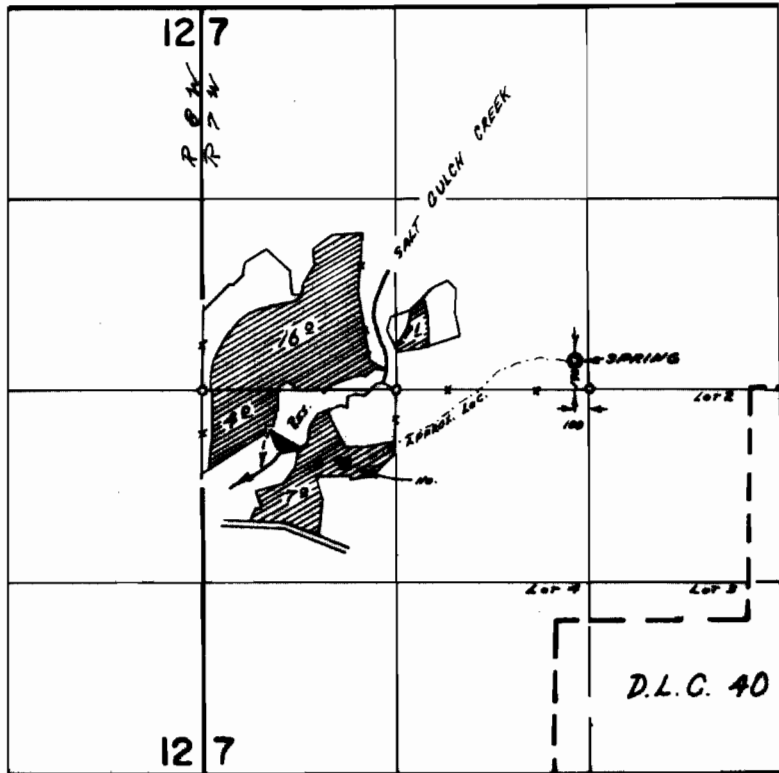

Div. Pt. Loc: 360' S. & 570' E. FROM NW COR. SEC. 7

FINAL PROOF SURVEY
UNDER

R-41470 R-4608
 41382 30623
 Application No. 25235 Permit No. 33793
 IN NAME OF

.....CHARLES S. MOORE.....

Surveyed APR 17 1970, by D. R. BUELL