

27163  
38459

# T.37S.R.24E.W.M.

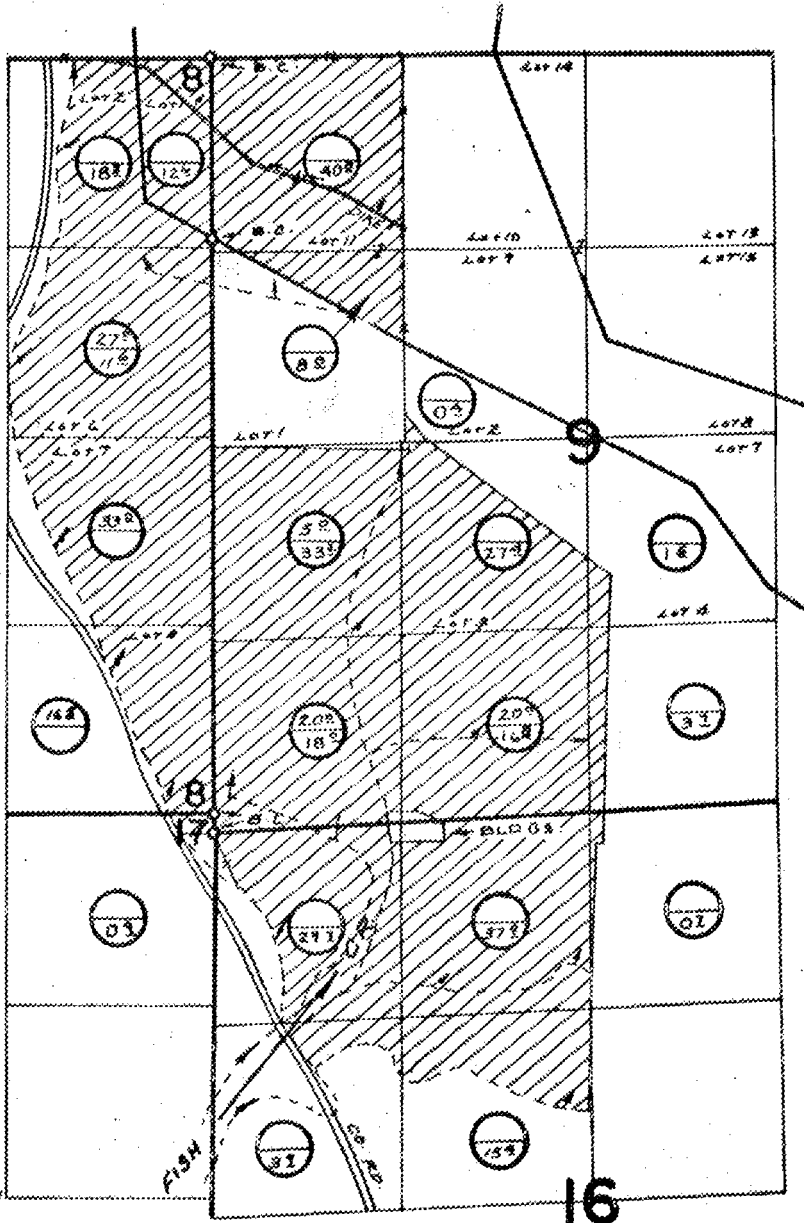
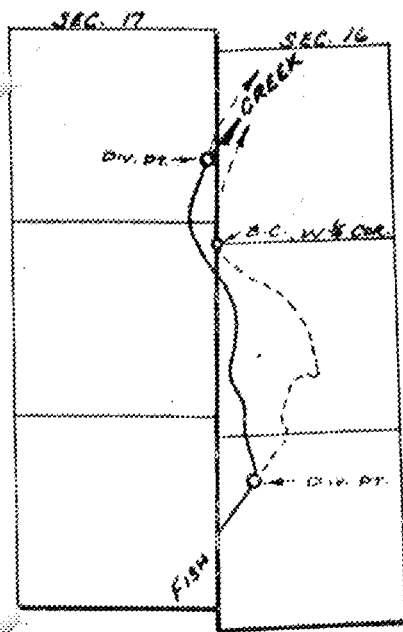

DN PTS. LOC: S80°N. (70°W) 1630'S. E  
280'E. BATH FROM SW C. COR. SEC. 16

→ CERT. 9458 & 9454  
→ APPL. 31340  
BOTH SUPPLEMENTAL APPL. 34587

## FINAL PROOF SURVEY

UNDER

Application No. <sup>31340</sup>~~34587~~ Permit No. <sup>24697</sup>~~27163~~

IN NAME OF

JERRY BARRY, JR.

Surveyed July 20 1970, by R. MUCKEN