

# T. 2 S. R. 4 W. W. M.

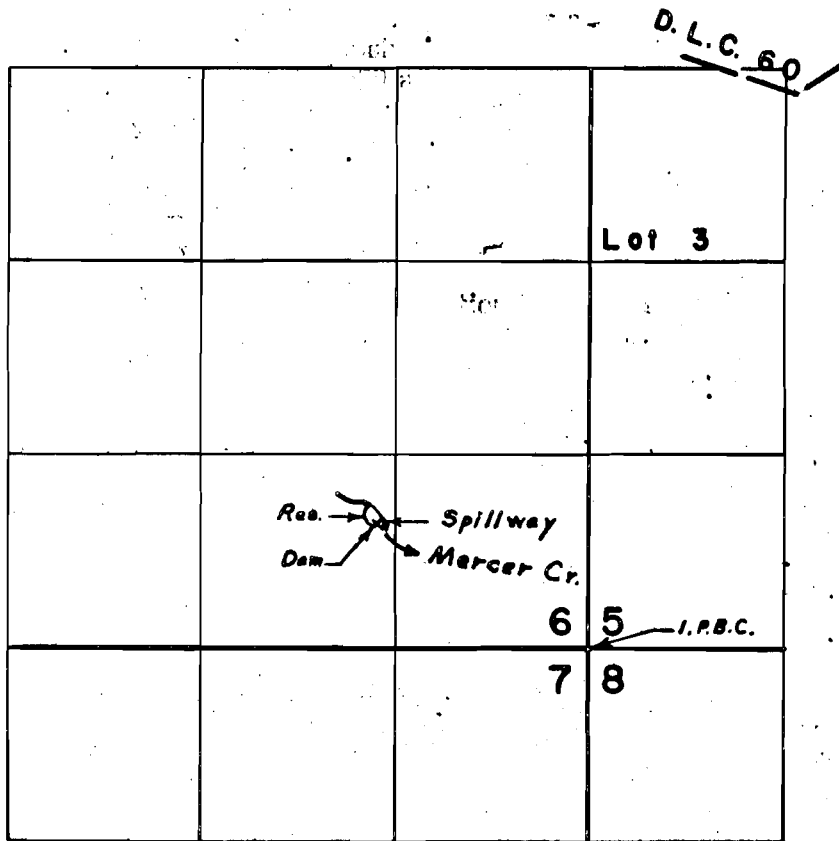

Div. Pt. located 840' N. & 1480' W. from S.E. Cor. Sec. 6

## FINAL PROOF SURVEY UNDER

R-45748                      R-5430  
 Application No. 45749 Permit No. 34148  
 IN NAME OF

GLENN R. PHILLIPS

Surveyed July 27, 1971, by L. E. Gould