

T. 33 S. R. 2 E. W. M.

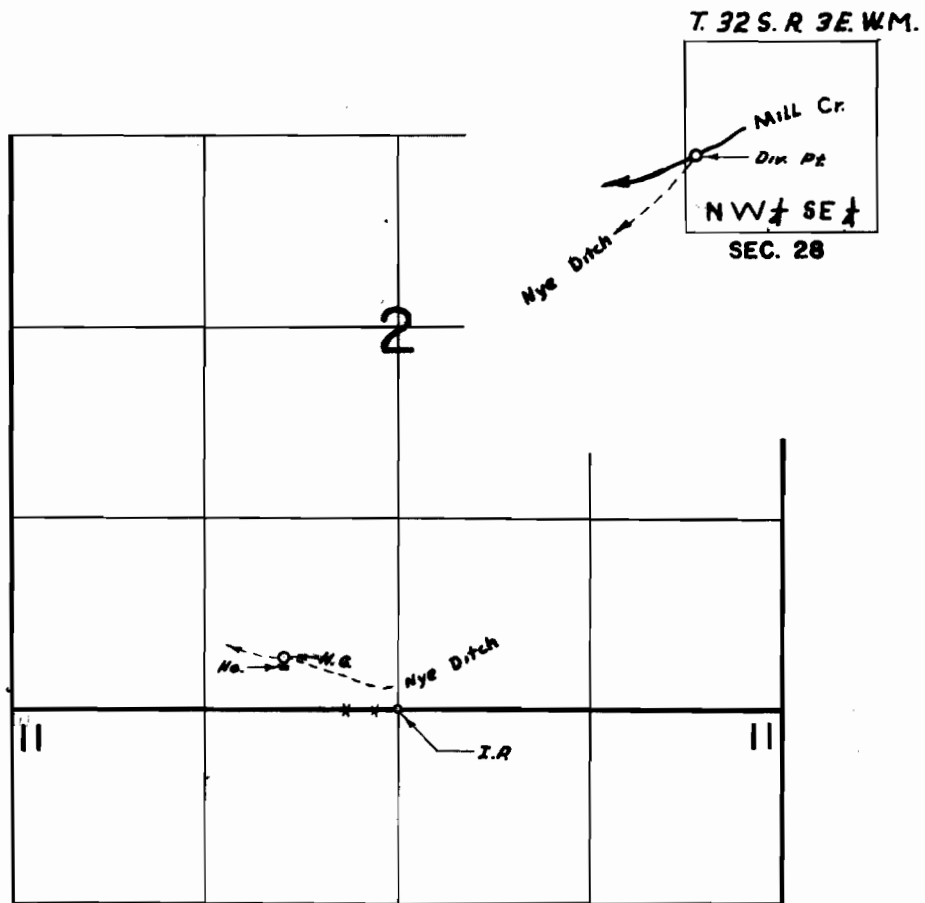

DIV. PT. LOC. 1860' N & 2690' E FROM SW COR. SEC. 28 T. 32 S. R. 3 E. W. M.

FINAL PROOF SURVEY
UNDER

Application No. 42522... Permit No. 317.77.....
IN NAME OF

ALEX J. TORREZ By: MARY M. POOLE

Surveyed SEP. 16., 1971, by L. E. Gould.....