

# T. 3 S. R. 5 W. W. M.

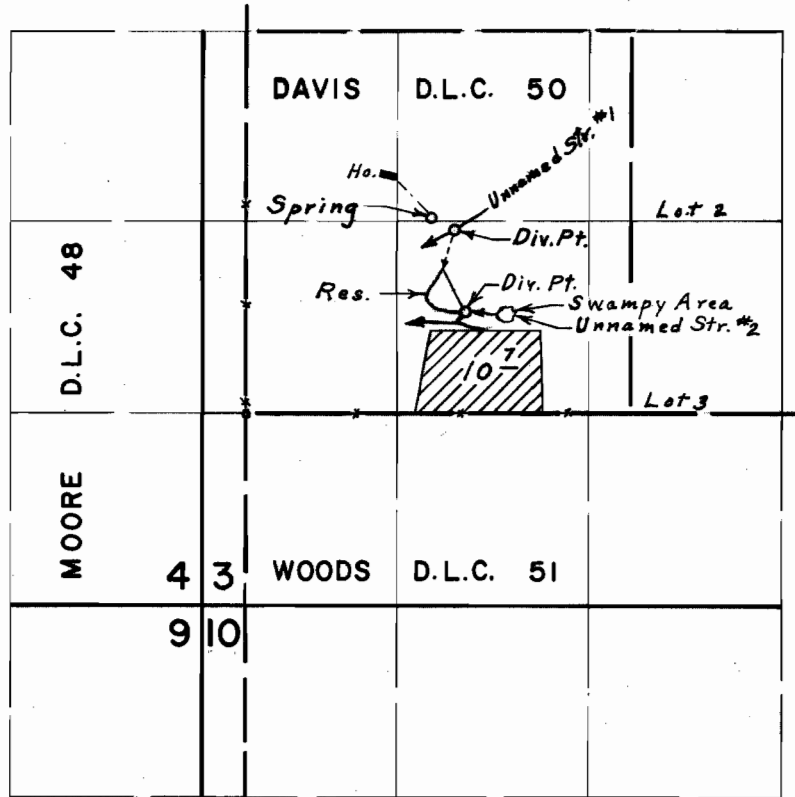

Div. Pts. located; Spr. 1340' N. & 1270' E.; Str. #1, 1250' N. & 1420' E.; Str. #2 680' N. & 1500' E.; all from S.E. Cor. Davis D.L.C. 50

## FINAL PROOF SURVEY UNDER

R-40201                      R-4489  
 Application No. 40202      Permit No. 29989  
 IN NAME OF

ESTATE OF ROBERT M. TURNER

Surveyed May 21, 1971, by L. E. Gould