

T. 3 S. R. 3 W. W. M.

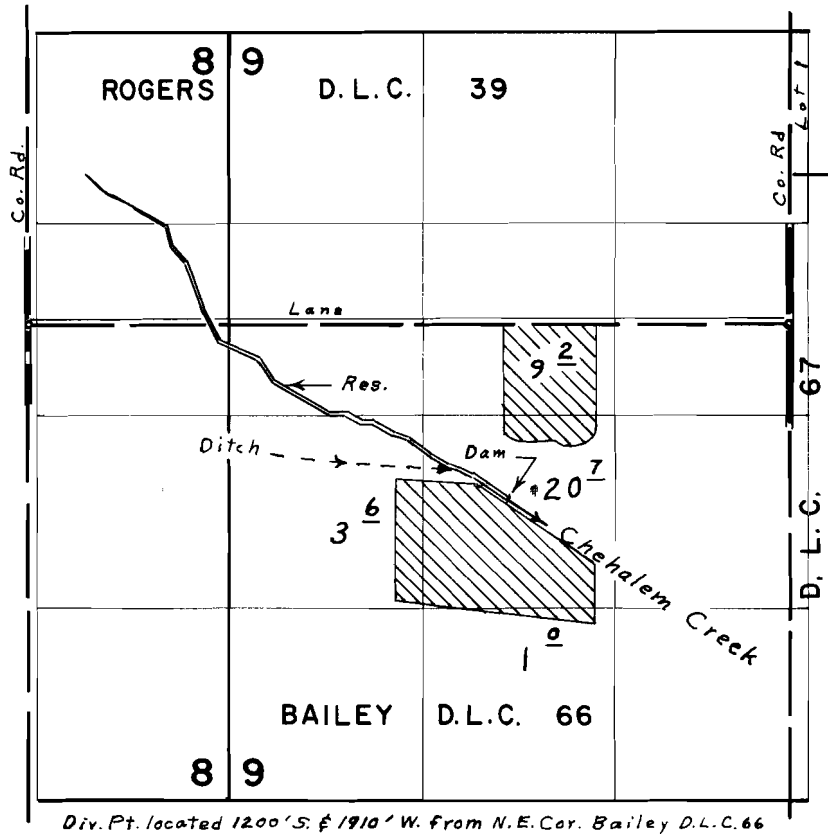

Div. Pt. located 1200' S. & 1910' W. from N.E. Cor. Bailey D.L.C. 66

FINAL PROOF SURVEY UNDER

R-41932 R-4781
 Application No. 41933 Permit No. 31455
 IN NAME OF

ELDON HAVEMAN

Surveyed Aug. 17, 1971, by L. E. Gould