

# T. 3 S. R. 3 W. W. M.

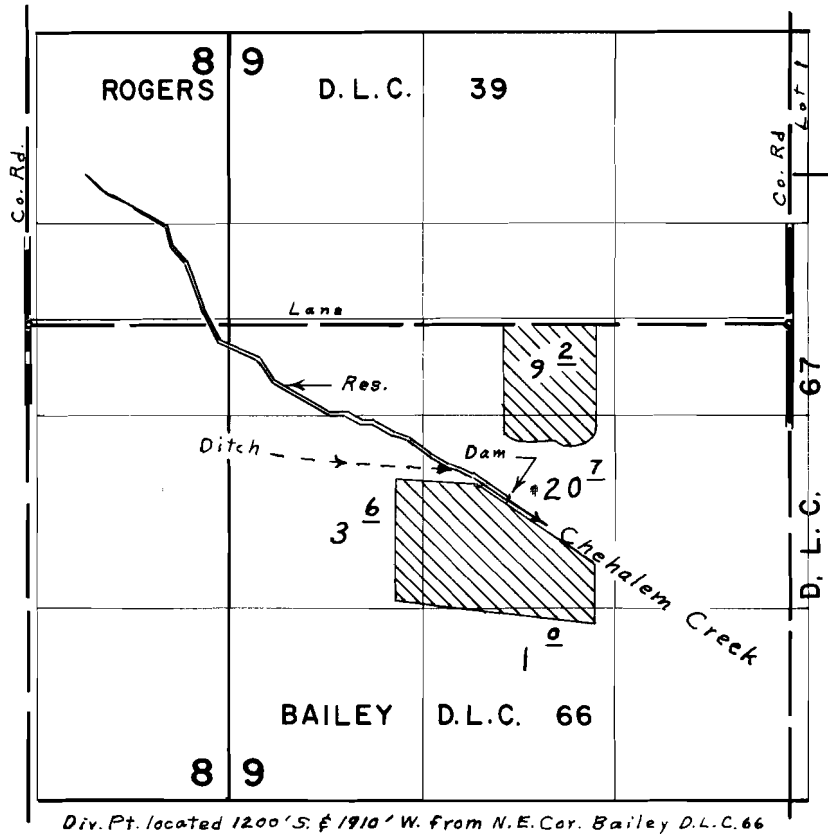

Div. Pt. located 1200' S. & 1910' W. from N.E. Cor. Bailey D.L.C. 66

## FINAL PROOF SURVEY UNDER

R-41932                      R-4781  
 Application No. 41933    Permit No. 31455  
 IN NAME OF

**ELDON HAVEMAN**

Surveyed Aug. 17, 1971, by L. E. Gould.