

# T. 2 S. R. 3 W. W. M.

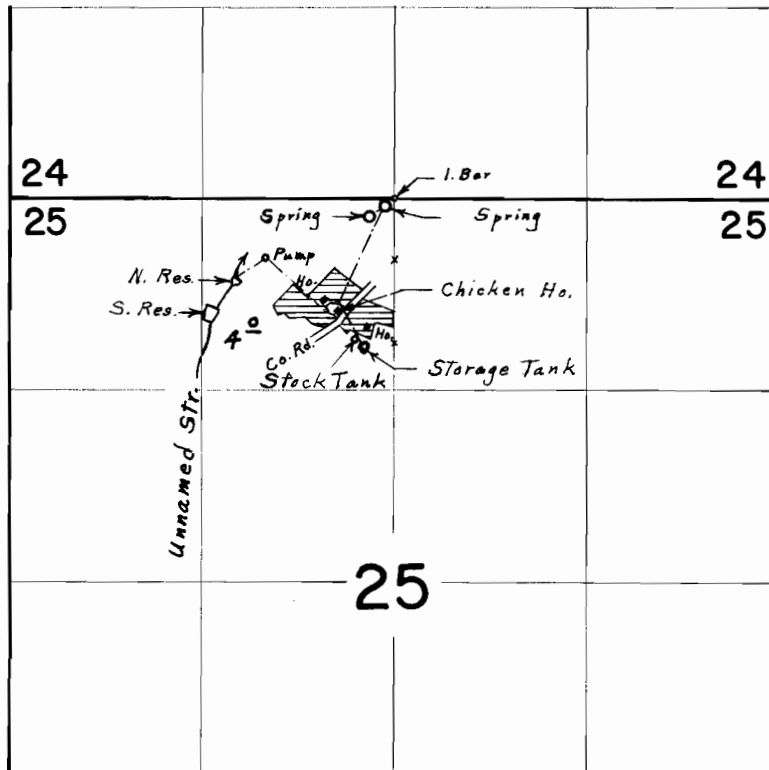

Div. Pts. located: Spring, 60' S. & 70' W.; N. Res., 540' S. & 1090' W.;  
S. Res., 760' S. & 1210' W.; all from N.  $\frac{1}{4}$  Corner Section 25

## FINAL PROOF SURVEY UNDER

R-43252                      R-4955  
Application No. 43253    Permit No. 32333

IN NAME OF

FLOYD & DOROTHY HOFFMAN

Surveyed April 28, 1971, by L. E. Gould