

# T. 3 S. R. 3 W. W. M.

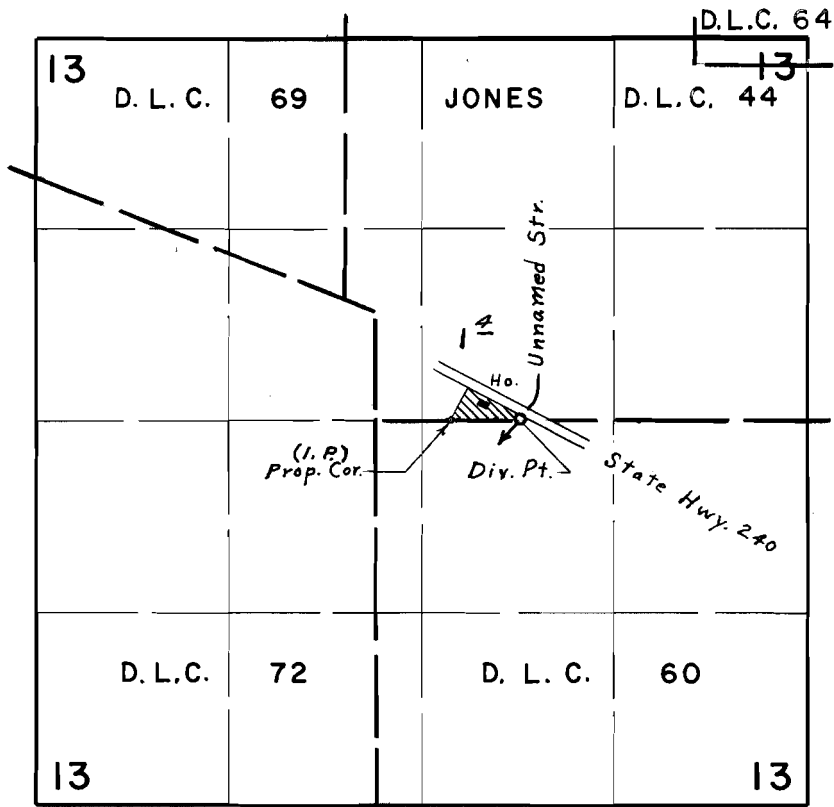

*Div. Pt. located 10' N. & 980' E. from S.W. Cor. Jones D.L.C. 44*

## FINAL PROOF SURVEY UNDER

Application No. 43662 Permit No. 32640  
IN NAME OF

RAY GARLAND

Surveyed July 30, 1971, by L. E. Gould