

T.7S.R.19E.W.M.

Superseded by  
1971-A Survey

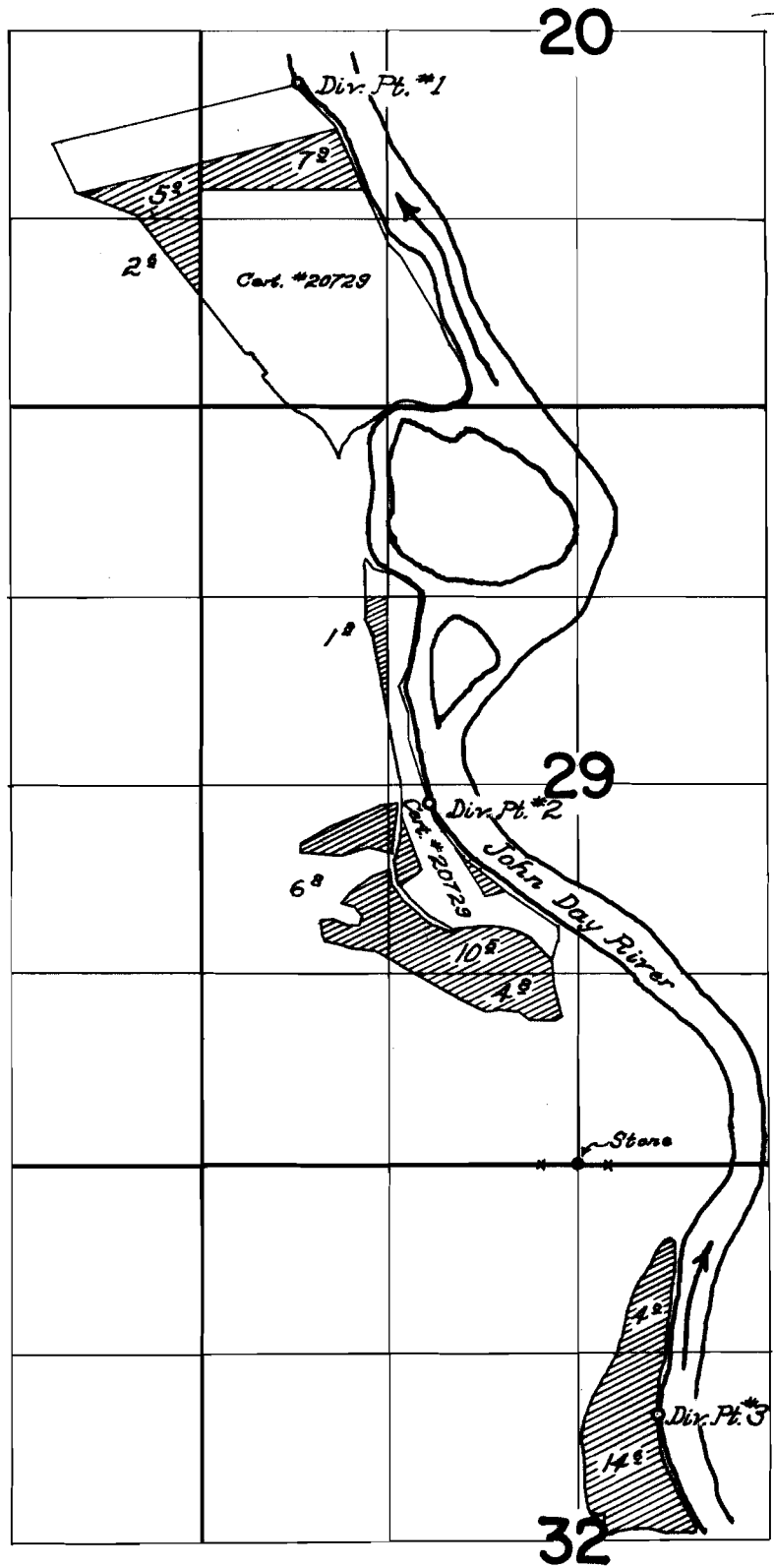

# FINAL PROOF SURVEY

UNDER

Application No. 33448      Permit No. 26435

IN NAME OF

Frank T. & Edna June Thomsen

Surveyed October 3 & 4, 1962, by Thomas R. Lauer

T.7S.R.19E.W.M.

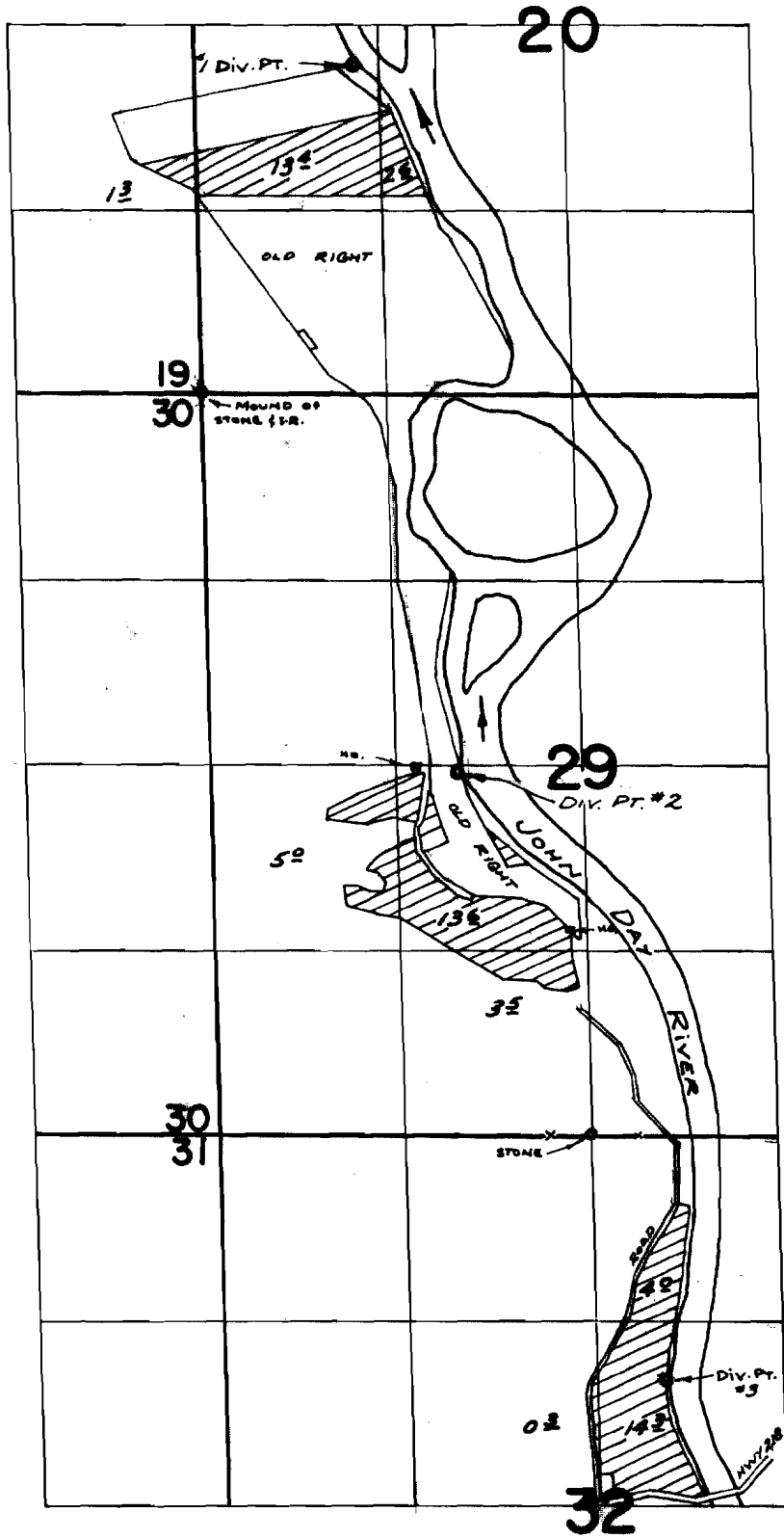

FINAL PROOF SURVEY

UNDER

Application No. ~~33448~~ Permit No. 26435

IN NAME OF

**FRANK T. & EDNA JUNE THOMPSON**

Surveyed Oct 31 1962, by THOMAS R. LAUER