

# T. 10 S. R. 35 1/2 & 36 E. W. M.

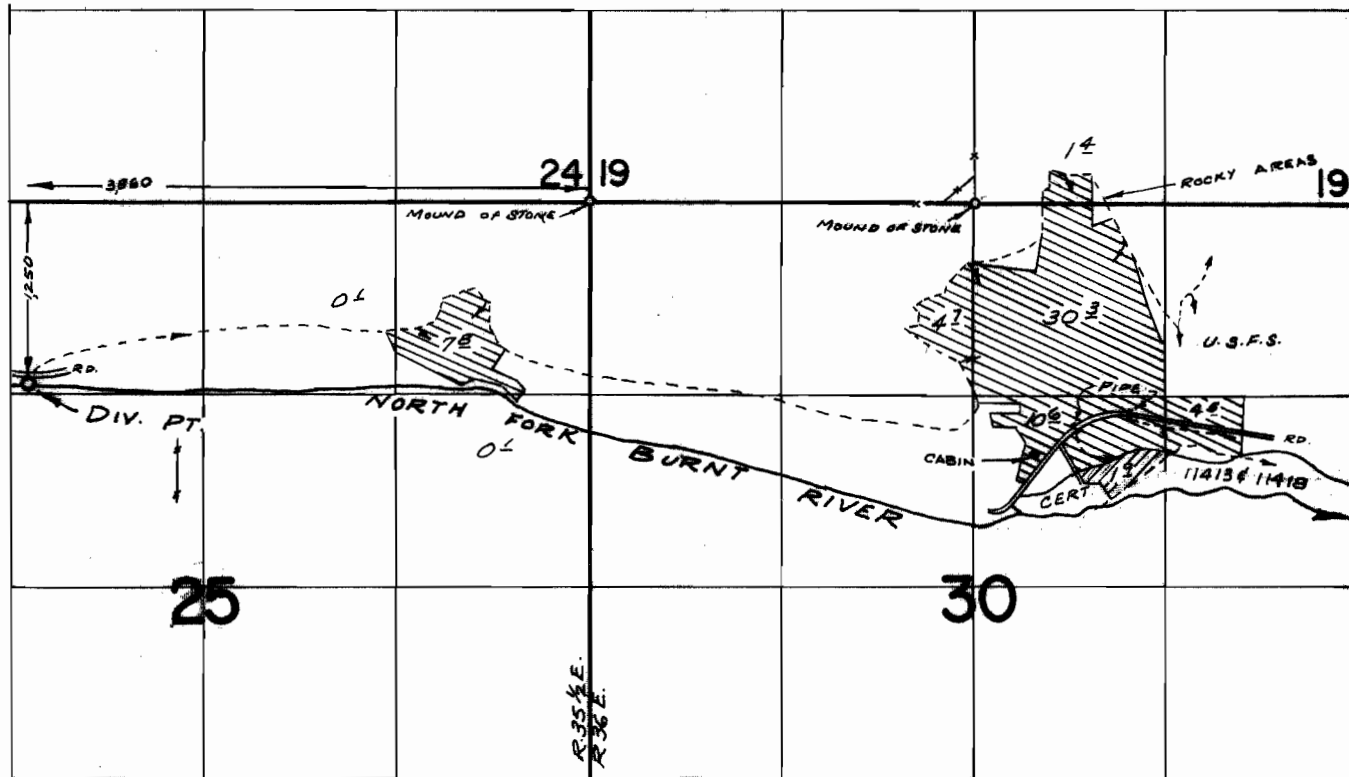

 PRIMARY
  SUPPLEMENTAL

## FINAL PROOF SURVEY UNDER

Application No. 33975 Permit No. 26818  
IN NAME OF

EUGENE V. RICCO

Surveyed SEPT. 2, 1971, by R. MUCKEN