

T 2 S. R. 1 E. W. M.

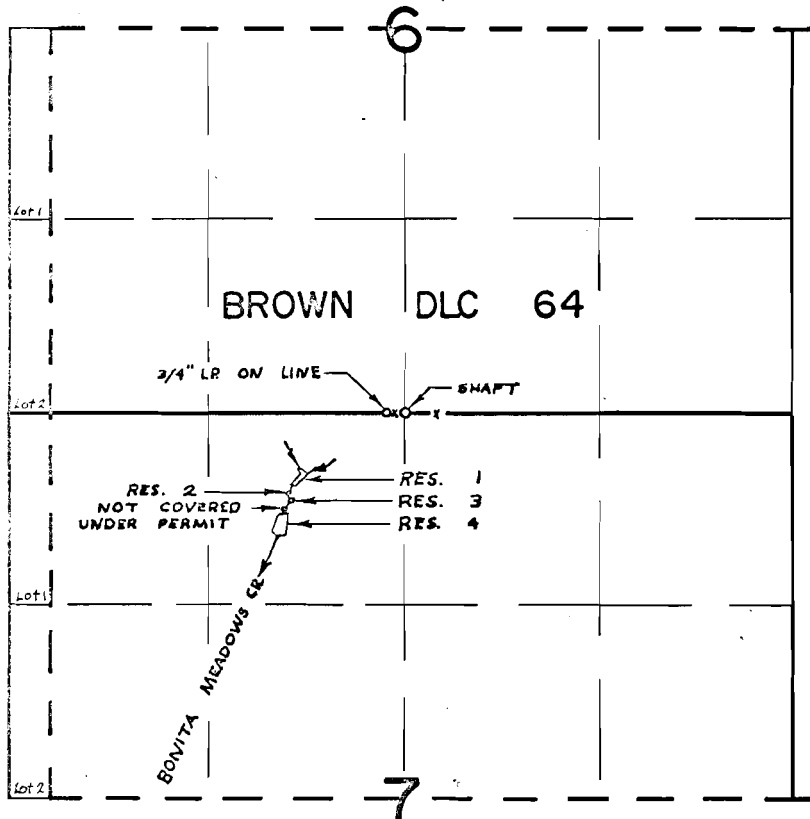

DIV PTs. LOC: RES 1-490' S & 750' W; RES 2-560' S & 790' W;
 RES 3-620' S & 770' W; RES 4-840' S & 850' W ALL FROM
 N 1/4 COR. SEC. 7

FINAL PROOF SURVEY UNDER

R-40405 R-4648
 Application No.40406. Permit No.30791...
 IN NAME OF

.....BURT...SMITH.....

Surveyed JULY..27., 1971., by R...MUCKEN.....