

E
T.9S.R2W.W.M.

Copy from
3-42100

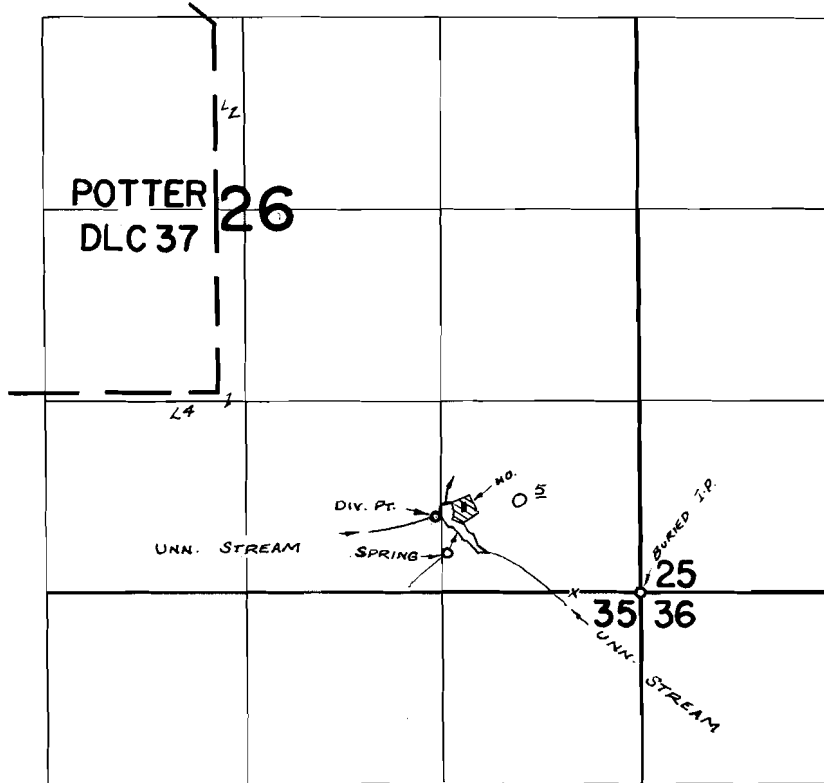

DIV. PT. UNN. STR. LOC: 620' N. & 1330' W;
DIV. PT. W. UNN. STR. LOC: 520' N. & 1390' W;
SPRING LOC: 260' N. & 1320' W; ALL FROM S.W. COR. SEC. 26

FINAL PROOF SURVEY
UNDER

Application No. R-42099 42100 Permit No. R-4746 31267
IN NAME OF

DEAN L. & MILDRED G. JETER

Surveyed MAY 5, 1970, by R. MUCKEN