

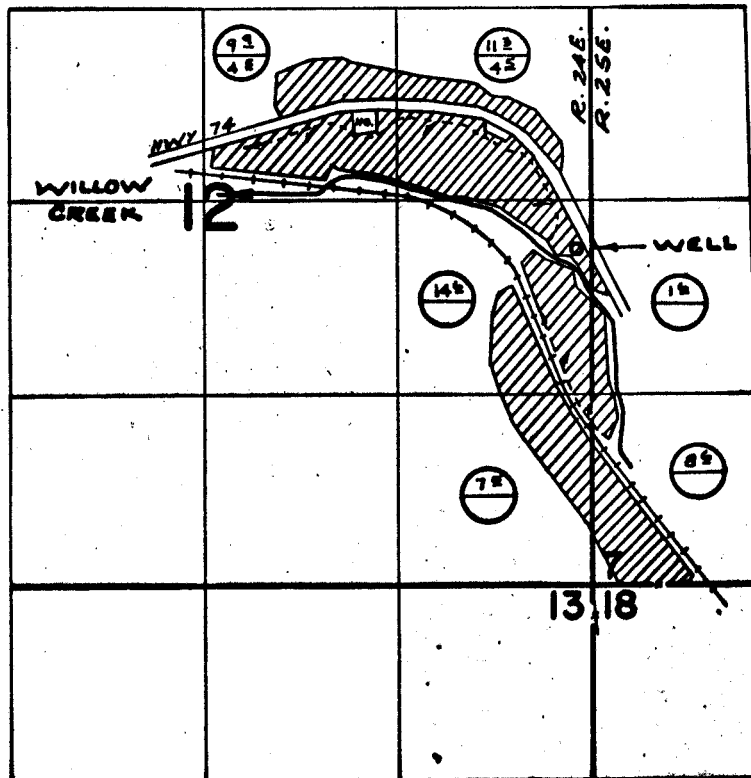

T.1S.R.24 & 25E.W.M.



WELL LOC: 100' W. & 2290' N. FROM SE. COR. SEC. 12

 PRIMARY
 SUPPLEMENTAL

FINAL PROOF SURVEY UNDER

Application No. G-4640 Permit No. G-1364
IN NAME OF

MARION & GENEVA PALMER

Surveyed May 13, 1971, by R. MURPHY