

Basin 7.

G-3300

38731

REGISTERED
ENGINEER
STATE OF OREGON

FREDERICK H. & BERNICE J. MOW

Containing 5 acres ±, situated in the northwest quarter of the northeast quarter of Section 24, Township 6, Range 35, east of Willamette Meridian.

County of Umatilla
State of Oregon

Application No. G-3504
Permit No. G-3300

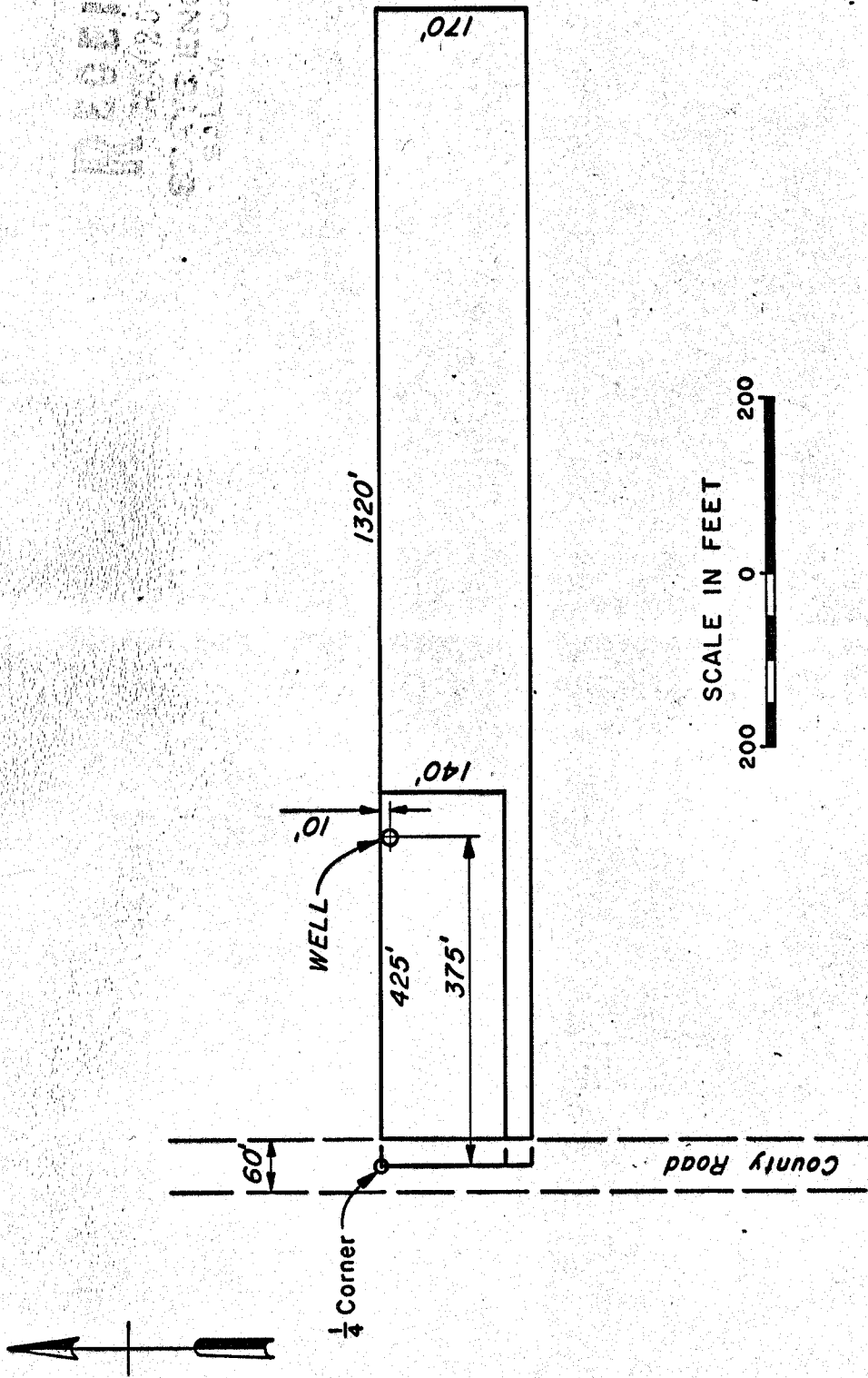

SCALE IN FEET

