

G-4771  
38741  
↑

# T 5 N. R. 29 E. W. M.

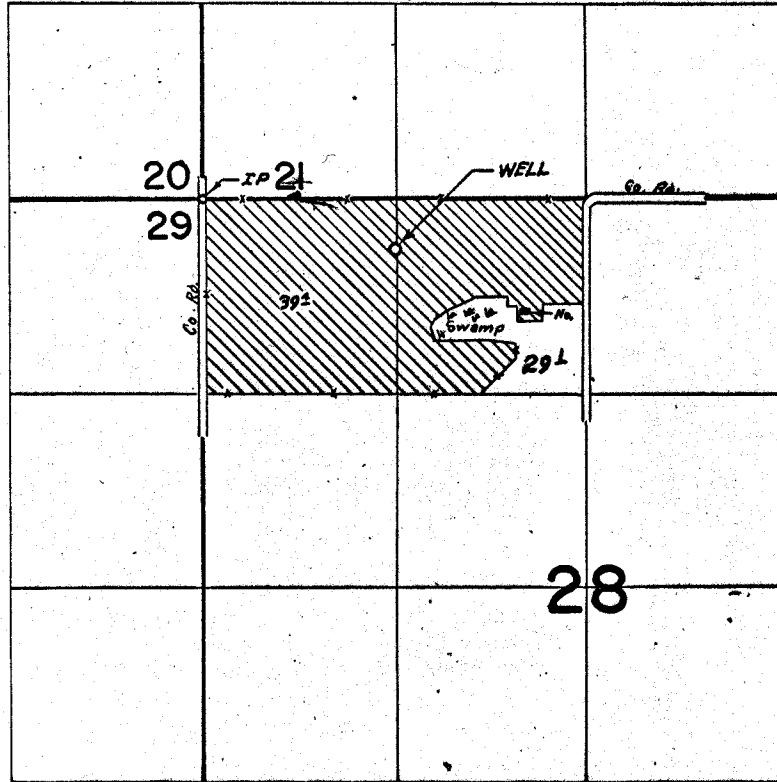

WELL LOC. 350' S & 1310' E FROM NW COR. SEC. 28

## FINAL PROOF SURVEY UNDER

Application No. G-5061. Permit No. G-4771.  
IN NAME OF

PHILLIP C. & MARIANNE BROWN

Surveyed NOV. 5., 1971, by J. E. Gould.

1971 J.E.P.