

A. 5248

SECTIONS 19 AND 20, T. 41 S. R. 18 E.

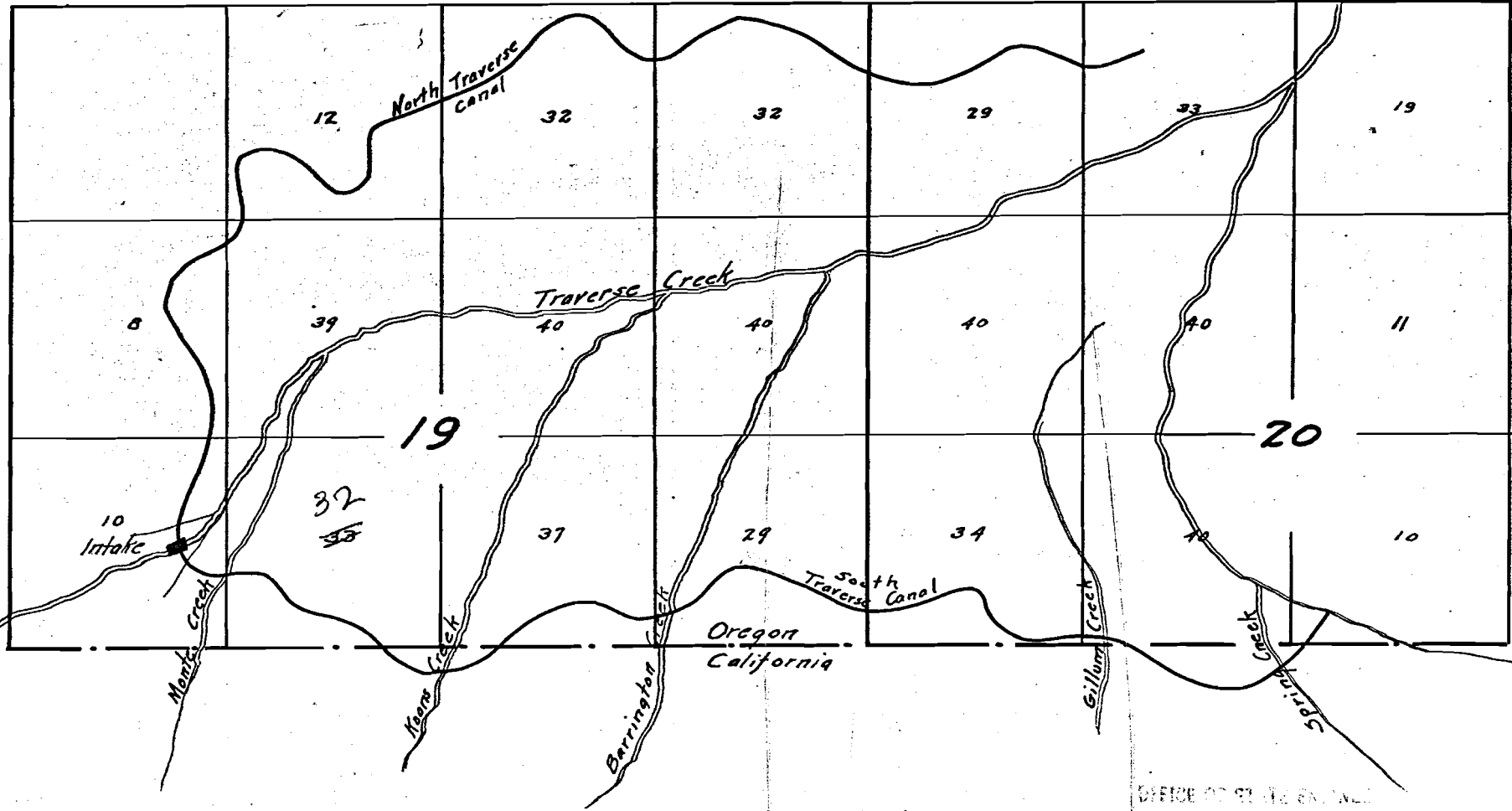

I, Kenneth A. Heron, do hereby certify that this map was made from notes taken during actual surveys made by me Nov. 1st and 2nd 1916 and that it correctly represents the location of streams and ditches in the immediate vicinity and that it has written thereon the area in each legal subdivision it is proposed to irrigate.

Kenneth A. Heron

5248
3199

OFFICE OF STATE ENGINEER
1916

3199
3877

11-8-16