

T. 30S., R. 7 W., W.M.

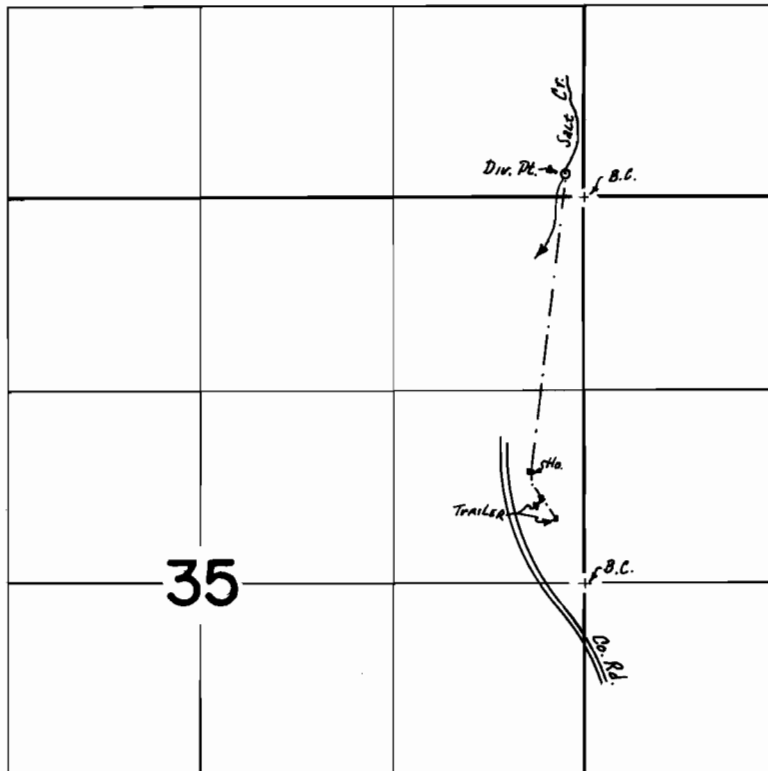

Div. Pt. located 150' N. & 130' W. from the NE cor. Sec. 35.

FINAL PROOF SURVEY
UNDER

Application No. 44587 Permit No. 33374
IN NAME OF

LEO & MARGARET HUMISTON

Surveyed Sept. 14 1972, by D. NORBY