

T.6N.R.35E.W.M.

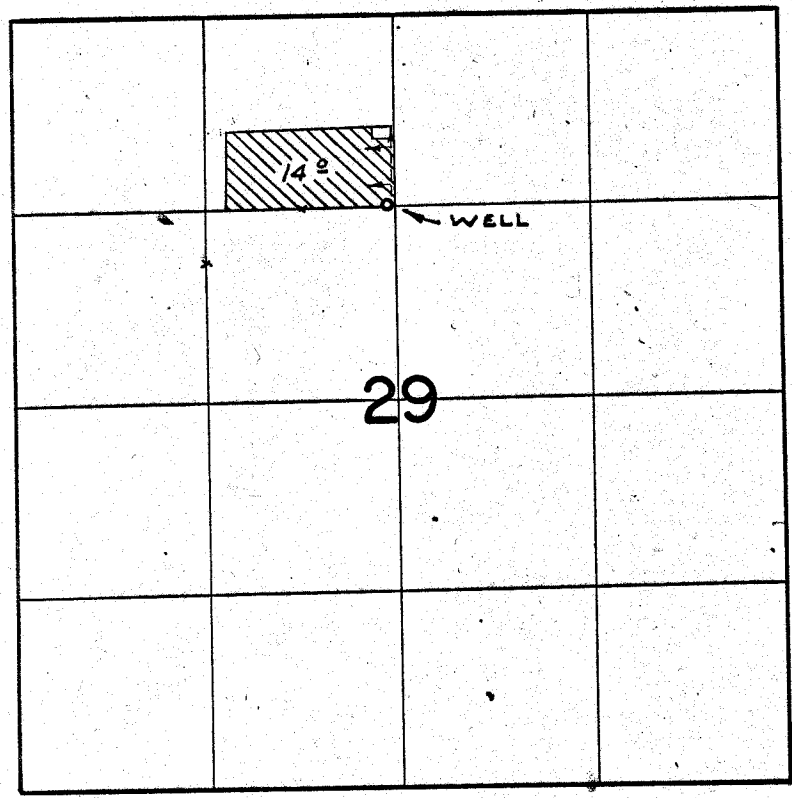

WELL LOC: 10' N. & 60' W. FROM S.E. COR. NE 1/4 NW 1/4 SEC. 29

FINAL PROOF SURVEY UNDER

Application No. G-3421 Permit No. G-3207
IN NAME OF

WALTER ROLOFF

Surveyed Aug. 30, 1971, by G. BACA