

G-9151
398600

T. 3 & 4 N. R. 28 E. W. M.

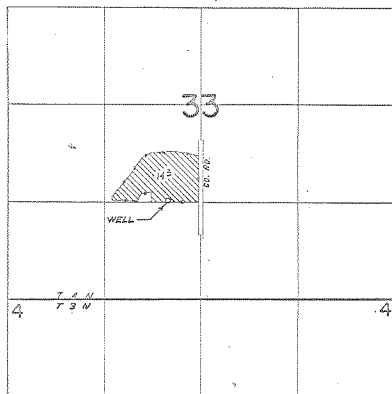

WELL LOC. 20' N & 450' W FROM SE COR. NE 1/4 SW 1/4 SEC. 33

FINAL PROOF SURVEY
UNDER

Application No. G-4404. Permit No. G-4151...
IN NAME OF

HOWARD S. & VERA G. STONE

Surveyed AUG. 26, 1971., by L. GOULD.....