

T.2 N.R.27 E.W.M.

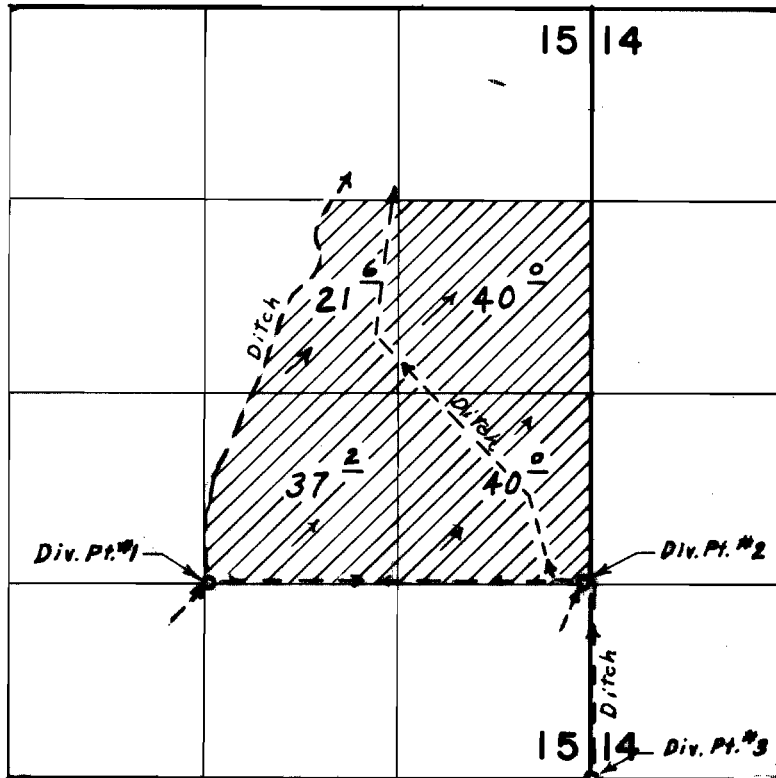

Div. Pts. located: #1, 1330' N. & 2610' W.; #2, 1350' N. & 30' W.; #3, 10' N. & 10' E., all from S.E. Cor. Sec. 15

FINAL PROOF SURVEY UNDER

Application No. 45873. Permit No. 34247.
IN NAME OF

OSCAR D. McCARTY

Surveyed Nov. 3, 1971, by L. E. Gould.