

T. 1 S. R. 2 W. W. M.

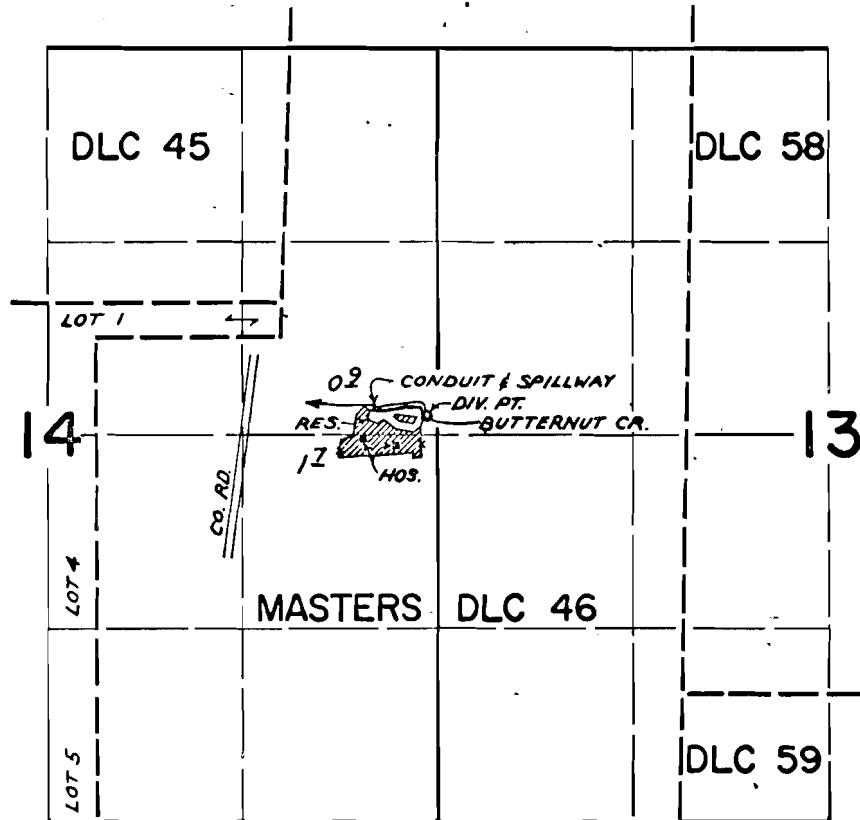

DIV. PTS. LOCATED: RES. 2810' N. & 430' W.; CR. 2780' N. & 80' W.; BOTH FROM SE. COR. SEC. 14

FINAL PROOF SURVEY UNDER

Application No. R-43019 43020 Permit No. R-4898 32162
IN NAME OF

GEORGE DIMEO

Surveyed SEPT. 15, 1971, by GREG. BACA