

T. 3 S. R. 8 W. W. M.

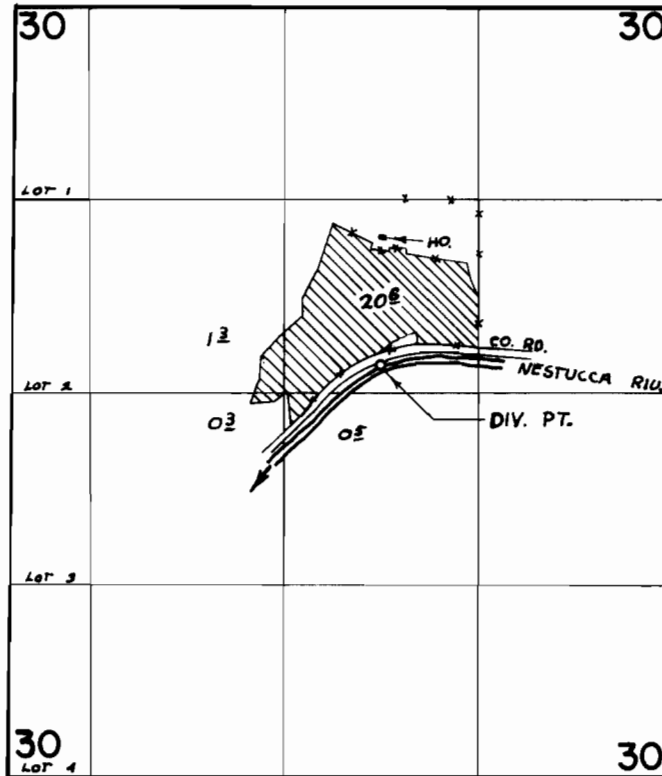

DIV. PT. LOC. 1130' S. & 670' W FROM NE COR. SW1/4 NE1/4

FINAL PROOF SURVEY
UNDER

Application No. 37463... Permit No. 27891.....
IN NAME OF

.....ERNEST G. HARRIS.....

Surveyed AUG. 12., 1971., by R. MUCKEN.....