

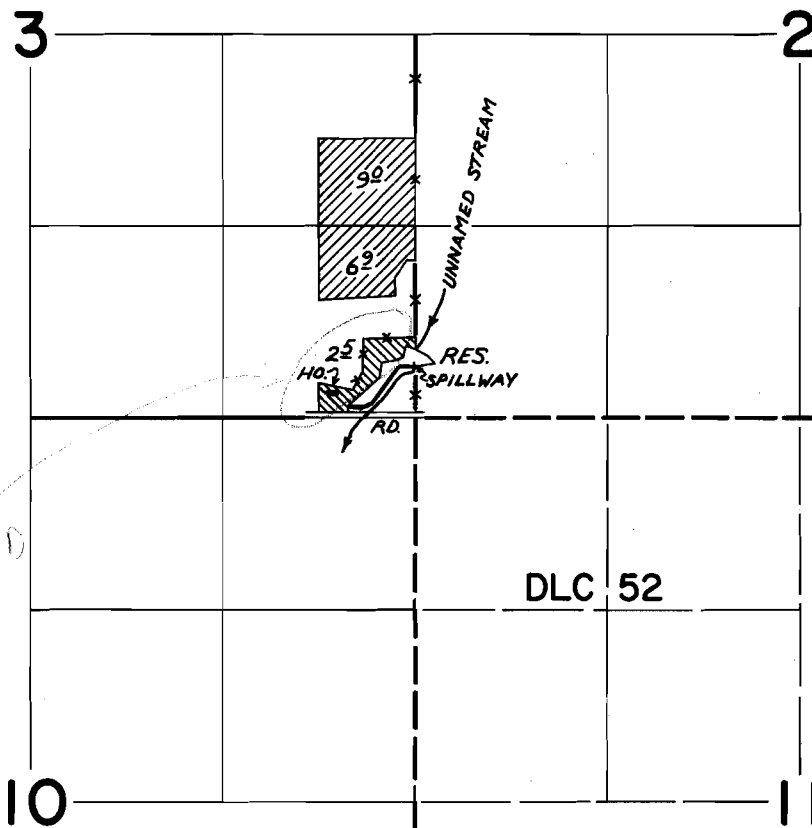

T. 1 N. R. 4 W. W. M.



SEE
COR.
THIS AREA
IS ALREADY

DIV. PT. LOCATED 350' N. & 20' W. FROM SE. COR. SEC. 3

 PRIMARY

 SUPPLEMENTAL

FINAL PROOF SURVEY UNDER

Application No. R-40658 40659 Permit No. R-4556 30289
IN NAME OF

WAYNE D. HENSLEY

Surveyed MAY 28 1971, by GREG BACA