

T.1N.R.3W.W.M.

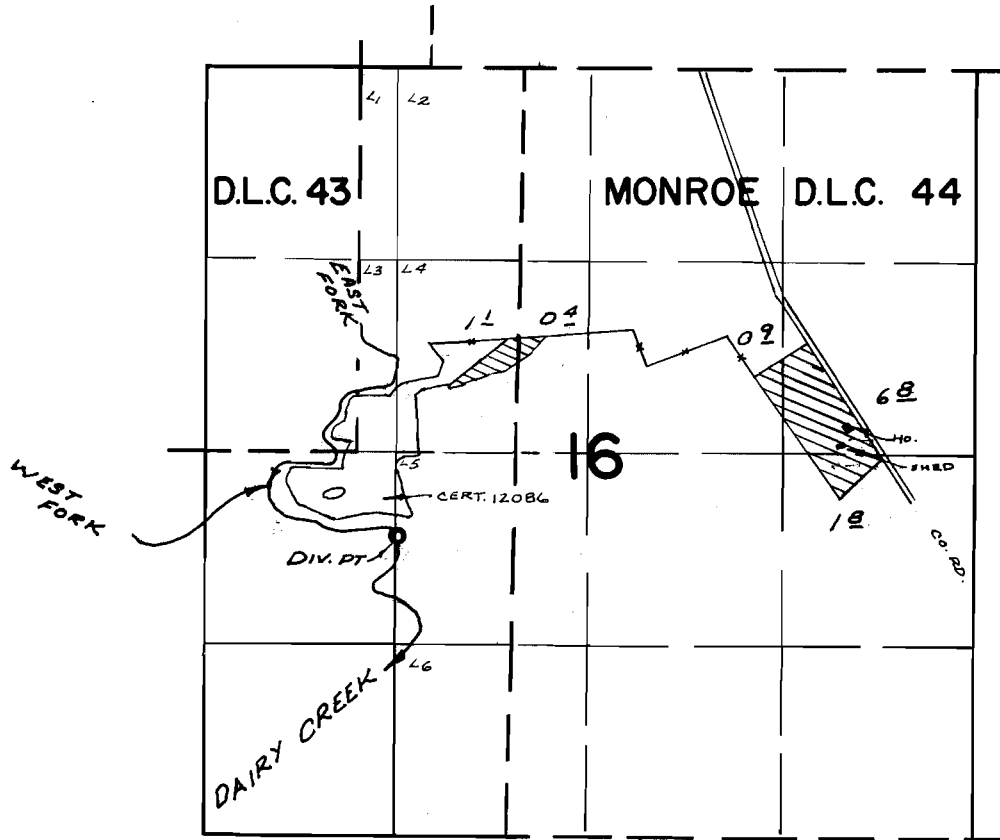

DIV. PT. LOC: 3220'S. & 1290'W. FROM N 1/4 COR. SEC. 16

FINAL PROOF SURVEY UNDER

Application No. 43456 Permit No. 32606
IN NAME OF

GARY VANDEHEY

Surveyed APR. 21, 22, 1971, by R. MUCKEN