

T. 3 S. R. 5 W. W. M.

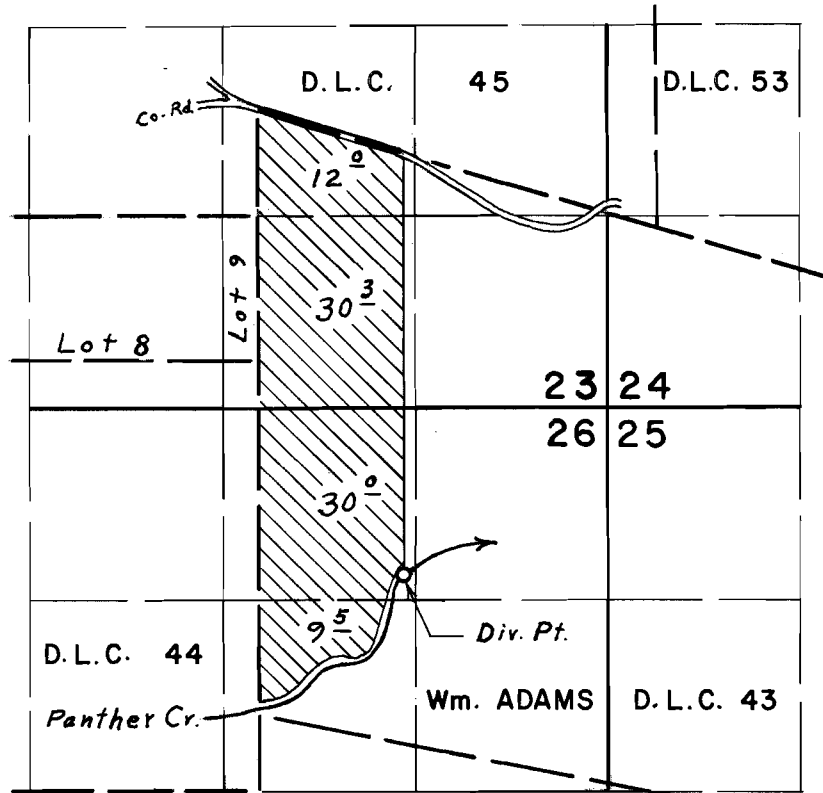

Div. Pt. located 320' S. & 980' E. From N.W. Cor. Wm. Adams D.L.C. 43

FINAL PROOF SURVEY UNDER

Application No. 40140 Permit No. 29922
IN NAME OF

SITTON BROTHERS

Surveyed Oct. 29, 1971, by L. E. Gould