

R-4587
34477 39046

T. 13 S. R. 30 E. W. M.

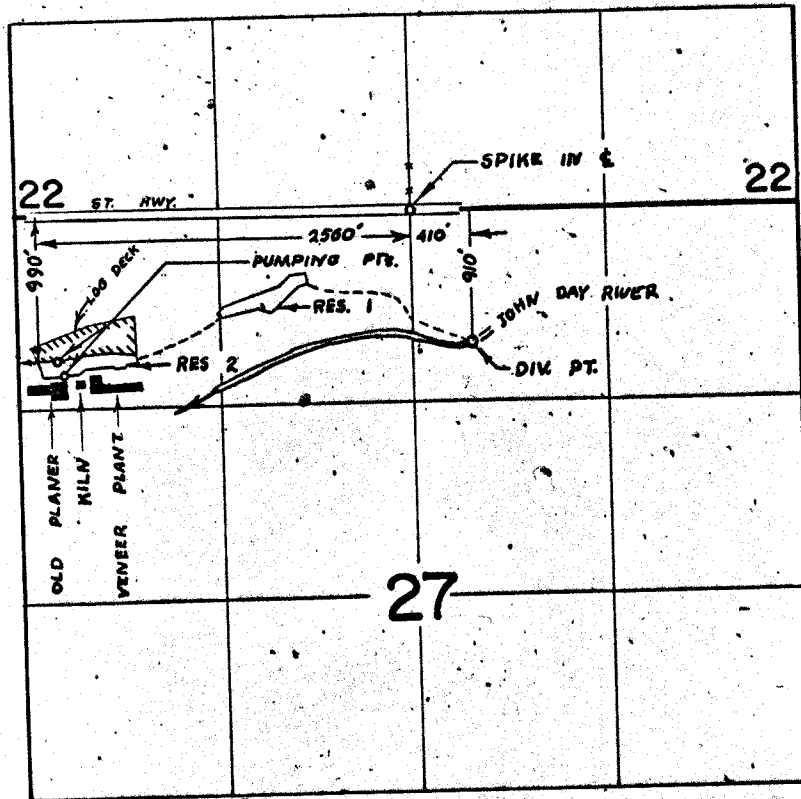

FINAL PROOF SURVEY
UNDER

Application No. R-46147 46148 Permit No. R-5487 34477

IN NAME OF
EDWARD HINES LUMBER CO.,
GRANT COUNTY DIVISION

Surveyed SEP. 1, 1971, by R. MUCKEN