

27531

T.2N.R.10E.W.M.

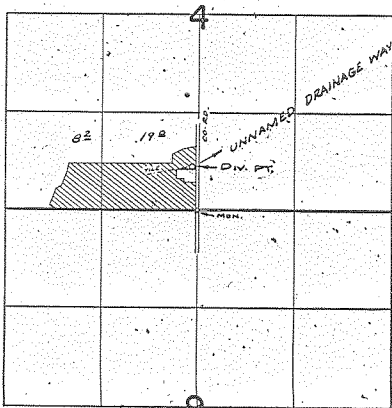

DIV. PT. 600' 590' N. & 70' W. FROM S. & COR. SEC. 4

FINAL PROOF SURVEY
UNDER

Application No. 35816... Permit No. 27551...
IN NAME OF

JOHN H. & JANET H. BENNETT

Surveyed APR. 20, 1971, by G. BACA

R.G.M.
1971-A