

T. 6 S., R. 5 W., W.M.

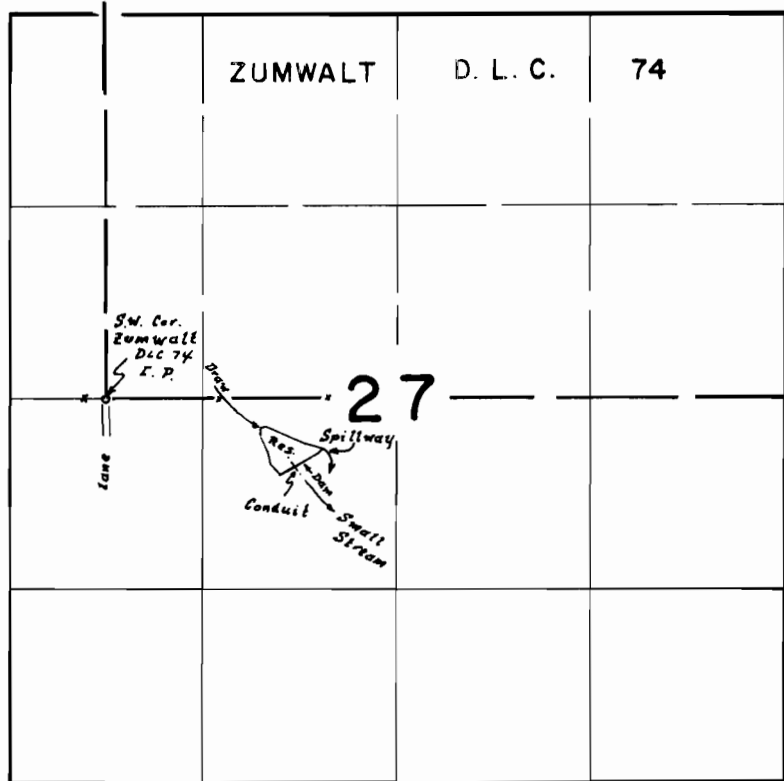

Div. Pt. 80c. 480' S. & 1280' E. From S.W. Cor. Zumwalt DLC 74

FINAL PROOF SURVEY
UNDER

Application No. R-47169. Permit No. R-5663.
IN NAME OF

MATT GILLES

Surveyed May 24, 1972, by L. E. Gould