

T.384S.R.12E.W.M.

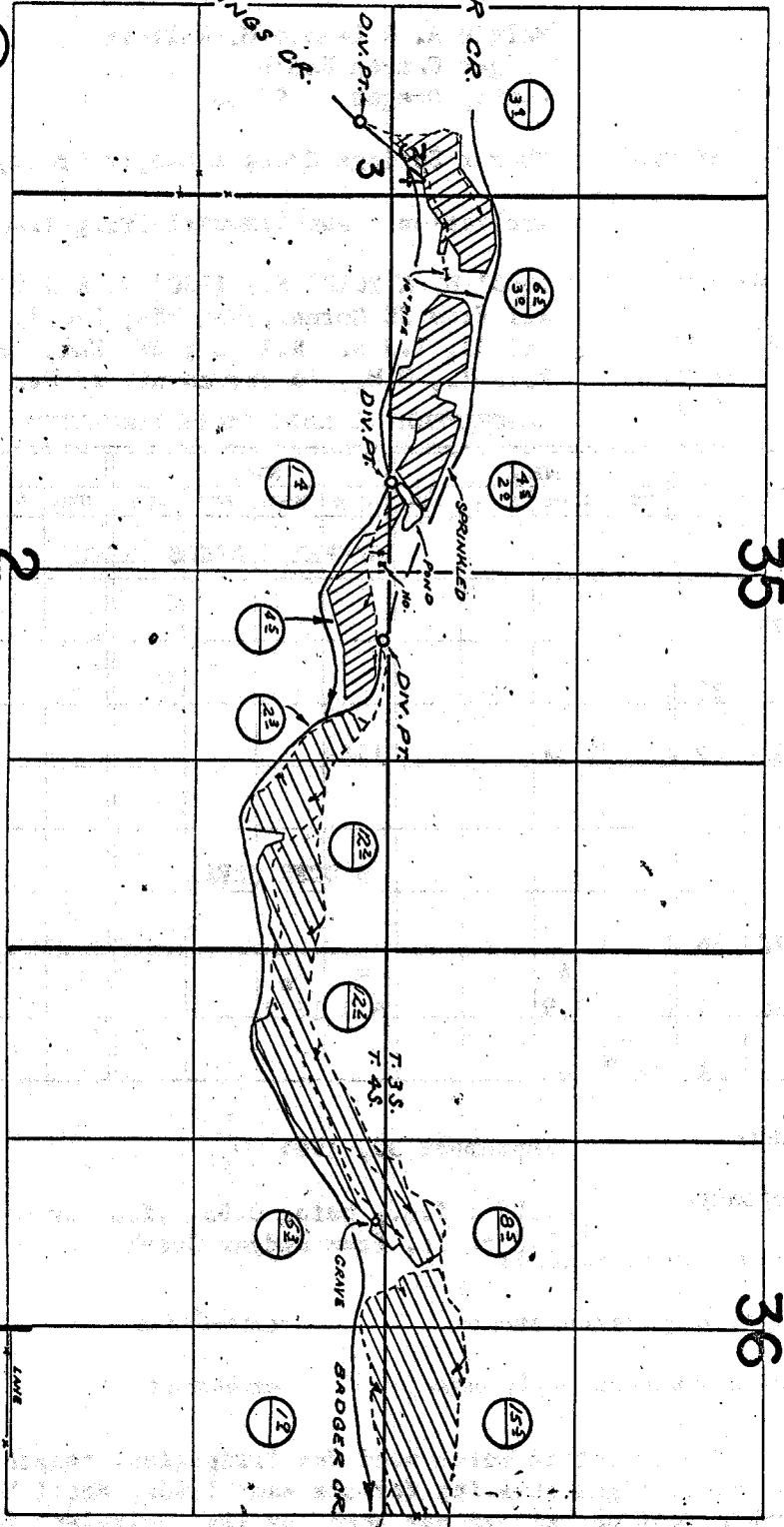

○ PRIMARY
 ○ SUPR - CERT. 5735, BADGER CR. & SPRINGS
 DIV. PTS. 100: 130°N. 152.0'W. 131.0'N. & 310.0'E. ALL FROM SE. COR. NE 1/4 NE 1/4 SEC. 3.
 ▨ BADGER CR.
 ▨ SHEERAR SPRING CR.

FINAL PROOF SURVEY

UNDER

Application No. 41445, P. 111, 112, 113, 30951

IN NAME OF

MELVIN A. & LENORE M. WALTERS

Surveyed Nov. 10, 1971, by R. MUCKEN