

T.I.S.R.I.W.W.M.

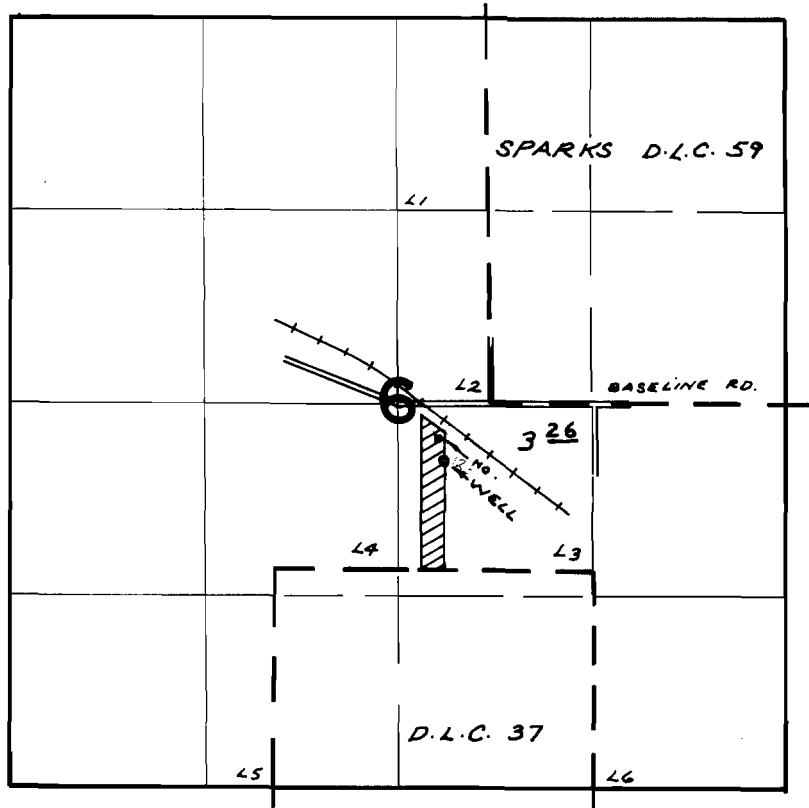

WELL LOC: 380'S. & 310'W. FROM S.W. COR. SPARKS D.L.C. 59

FINAL PROOF SURVEY UNDER

Application No. G-5270 Permit No. G-4931
IN NAME OF

C. E. NABB

Surveyed OCT. 30, 1972, by R. MURKEN