

# T. 3 S. R. 4 W. W. M.

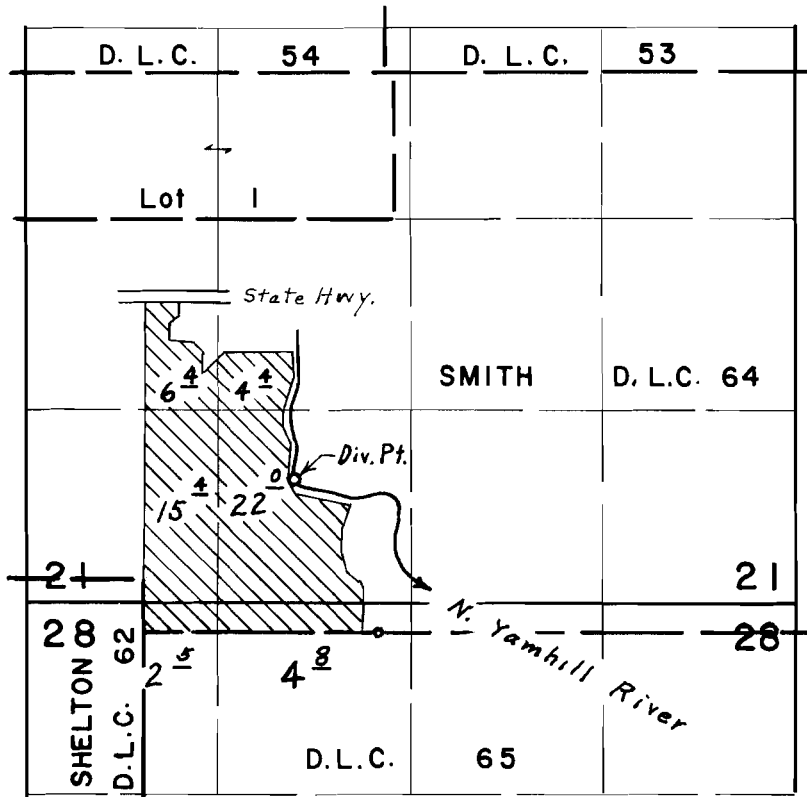

Div. Pt. located 690' N. & 1030' E, from N.E. Cor. Shelton D.L.C. 62

## FINAL PROOF SURVEY UNDER

Application No. 45640 Permit No. 34036

IN NAME OF

**FIDEL BROS.**

Surveyed Oct. 1, 1971, by L. E. Gould